



**CARBURETTER SETTINGS**  
**and**  
**SPARE PARTS LIST**  
**1940 to 1954 (inclusive)**  
**for**  
**BRITISH and OVERSEAS**  
**MOTOR CYCLE ENGINES,**  
**BICYCLE POWER UNITS,**  
**etc.**



**Holdford Road, Witton, BIRMINGHAM, 6, England.**

1940 to 1954 (inclusive) SETTINGS AND SPARE PARTS LIST

LIST No. 601/2  
(ISSUE NO. 2)

Machine and Engine Details			ENGINE END DETAILS							JET BLOCK		Jet Size	Throttle Valve	Needle Position	Needle Jet	Float Chbr. Type No.	Float Chbr. Body Part No.	Spare Parts List No.
Capacity	Model	Year	Carburettor Type No.	Mix. Chbr. Body No.	Internal Bore	Centre Line of Body to Face of Fl'ge	Flange Centres	Dia. of Bolt Holes	Dia. at Engine End	Part No.	Size No.							
<b>A.J.S.</b>																		
347 O.H.V.	16M, 16MC, 16MS ..	1946-49	76D/1J	76/014	1"	1 1/2"	2"	1 1/2"	1"	6/058	45	150	6/4	3	Std.	1J (15°)	64/186	440
347 O.H.V.	16M, 16MC, 16MS ..	1950	76AL/1AK	76/112	1"	2 1/2"	2"	1 1/2"	1"	6/058	45	150	6/4	3	Std.	1AK (3°)	64/303	440
347 O.H.V.	16M, 16MC, 16MS ..	1951-53	76AE/1AK	76/014	1"	1 1/2"	2"	1 1/2"	1"	6/058	45	150	6/4	3	Std.	1AK (3°)	64/303	440
347 O.H.V.	16MCS .. ..	1950-53	76AE/1AK	76/014	1"	1 1/2"	2"	1 1/2"	1"	6/058	45	150	6/4	3	Std.	1AK (3°)	64/303	440
347 O.H.C.	16M, 16MS, 16MSC ..	1954	76AV/IED	76/024	1 1/8"	1 1/2"	2"	1 1/2"	1 1/8"	6/059	51	150	6/4	3	Std.	1ED (3°)	64/303B	440
347 O.H.V.	7R Racing .. ..	1949-53	T10 TT9	175/293	1 1/8"	1 1/2"	2"	1 1/2"	1 1/8"	175/101D	—	400	4	4	-109	302/3	302/015	449
498 O.H.V.	18, 18C, 18S .. ..	1946-49	89B/1AK	89/403	1 3/32"	1 1/2"	2"	1 1/2"	1 3/32"	29/068	54	180	29/4	3	Std.	1AK (3°)	64/303	440
498 O.H.V.	18, 18C, 18S .. ..	1950	89M/1AK	89/150	1 3/32"	2 1/2"	2"	1 1/2"	1 3/32"	29/068	54	180	29/4	3	Std.	1AK (3°)	64/303	440
498 O.H.V.	18, 18C, 18S .. ..	1951-53	89B/1AK	89/403	1 3/32"	1 1/2"	2"	1 1/2"	1 3/32"	29/068	54	180	29/4	3	Std.	1AK (3°)	64/303	440
498 O.H.V.	18, 80, 54G .. ..	1954	89N/IED	89/405	1 3/32"	1 1/2"	2"	1 1/2"	1 3/32"	29/070	61	180	29/4	2	Std.	1ED (3°)	64/303B	440
498 O.H.V.	18CS .. ..	1950-53	89B/1AK	89/403	1 3/32"	1 1/2"	2"	1 1/2"	1 3/32"	29/068	54	180	29/4	3	Std.	1AK (3°)	64/303	440
498 O.H.V.	20 Twin .. ..	1949-53	76AG/1AU	76/412	1"	1 1/2"	2"	1 1/2"	1"	6/058	45	180	6/4	3	Std.	1AU (7°)	64/192B	440
498 O.H.V.	20 Twin .. ..	1954	76AT/IEF	76/412	1"	1 1/2"	2"	1 1/2"	1"	6/058	45	180	6/4	3	Std.	1EF (7°)	64/192B	440
500 C.C.	Twin, L.H. Carb. } ..	1953	76AQ	76/411	1"	1 1/2"	2"	1 1/2"	1"	6/058(L.H.)	45	180	6/4	3	Std.	1DB (7°)	64/195	440
	R.H. Carb. } ..		76AP	76/412	1"	1 1/2"	2"	1 1/2"	1"	6/058	45	180	6/4	3	Std.	1AU (7°)	64/192B	440
<b>A.J.W.</b>																		
500 S.V.	Twin .. ..	1949-52	276DD/1E	276/004R	1 1/8"	1 1/2"	2"	1 1/2"	1 1/8"	206/057R	39	140	6/3	3	Std.	1E	64/154	440
<b>ARIEL.</b>																		
197 O.H.V.	Colt, LH .. ..	1954	275BU/1EM	275/004R	1 1/8"	1 1/2"	2"	1 1/2"	1 1/8"	205/057R	28	75	5/3	3	Std.	1EM (7°)	64/192B	440
350 O.H.V.	NH, (Ex W.D.) .. ..	1940-45	76A/2N	76/014	1"	1 1/2"	2"	1 1/2"	1 1/8"	6/058	45	150	6/4	3	-107	2N (15°)	64/187	440
350 O.H.V.	NG (Ex W.D.) .. ..	1940-45	75B/2N	75/014	7/8"	1 1/2"	2"	1 1/2"	1 1/8"	5/058	33	110	5/4	3	Std.	2N (15°)	64/187	440
350 O.H.V.	W/NG (Ex W.D.) .. ..	1940-45	275A/2N	275/014R	7/8"	1 1/2"	2"	1 1/2"	1 1/8"	205/058R	33	120	5/4	3	Std.	2N (15°)	64/187	440
350 O.H.V.	W/NG (Ex W.D.) .. ..	1940-45	275B/1J	275/014R	7/8"	1 1/2"	2"	1 1/2"	1 1/8"	205/058R	33	120	5/4	3	Std.	1J (15°)	64/186	440
500 O.H.V.	VG (Ex W.D.) .. ..	1940-45	76C/2N	76/024	1 1/8"	1 1/2"	2"	1 1/2"	1 1/8"	6/059	51	170	6/4	3	Std.	2N (15°)	64/187	440
500 O.H.V.	VA (Ex W.D.) .. ..	1940-45	276E/6BC	276/112R	1"	2 1/2"	2"	1 1/2"	1"	206/058R	45	140	6/4	3	-107	6BC (15°)	14/603	440
347 O.H.V.	NG .. ..	1946-50	275S/1J	275/400R	7/8"	1 1/2"	2"	1 1/2"	1 1/8"	205/058R	33	120	5/4	3	Std.	1J (15°)	64/186	440
347 O.H.V.	NH .. ..	1946-54	276AZ/1J	276/412R	1"	1 1/2"	2"	1 1/2"	1 1/8"	206/058R	45	150	6/4	3	-107	1J (15°)	64/186	440
498 O.H.V.	VG .. ..	1946-50	276BB/1J	276/413R	1 1/8"	1 1/2"	2"	1 1/2"	1 1/8"	206/059R	51	170	6/4	3	Std.	1J (15°)	64/186	440
497 O.H.V.	VH Red Hunter .. ..	1946-51	289D/1BM	289/403R	1 1/8"	1 1/2"	2"	1 1/2"	1 1/8"	229/069R	58	200	29/3	3	Std.	1BM (15°)	64/186B	440
497 O.H.V.	VH Red Hunter .. ..	1952-54	289S/1K	289/403R	1 1/8"	1 1/2"	2"	1 1/2"	1 1/8"	229/069R	58	200	29/3	3	Std.	1K	64/186B	440
497 O.H.V.	HS, Scrambler .. ..	1954	10TT9	175/048RR	1 3/16"	1 3/4"	2"	1 1/2"	1 3/16"	175/101D	1 3/16"	380	6	4	-109	14/534 (15°)	14/225R	449
498 O.H.V.	KG Standard .. ..	1946-49	276DA/1DU	276/004R	1 1/8"	1 1/2"	2"	1 1/2"	1 1/8"	206/057R	39	140	6/3	3	-107	1DU	64/156B	440
498 O.H.V.	KG Standard .. ..	1950-52	276EF/1C	276/004R	1 1/8"	1 1/2"	2"	1 1/2"	1 1/8"	206/057R	39	140	6/3	3	-107	1C	64/156B	440
498 O.H.V.	KH Red Hunter .. ..	1946-49	276DE/1DU	276/014R	1"	1 1/2"	2"	1 1/2"	1"	206/058R	45	150	6/3	3	-107	1DU	64/156B	440
498 O.H.V.	KH Red Hunter .. ..	1950-54	276EG/1C	276/014R	1"	1 1/2"	2"	1 1/2"	1"	206/058R	45	150	6/3	3	-107	1C	64/156B	440
500 C.C.	Twin, R.H. (K.H.) .. ..	1953-54	276FQ/1B	276/014R	1"	1 1/2"	2"	1 1/2"	1"	206/058R	45	150	6/3	3	-107	1B	64/156B	440
598 S.V.	VB .. ..	1946-54	276BP/1J	276/112R	1"	2 1/2"	2"	1 1/2"	1"	206/058R	45	160	6/4	3	Std.	1J (15°)	64/186	440
646 O.H.V.	FH Twin Huntmaster .. ..	1954	276GJ/1DB	276/427R	1 1/8"	1 1/2"	2"	1 1/2"	1 1/8"	206/059R	51	170	6/4	2	Std.	1DB (7°)	64/195	440
<b>ARROW.</b>																		
	Bicycle Power Unit .. ..	1952	308/15	308/003	.39"	1/2" dia.	Clip	Fitting		—	—	25	2	3	-078	Bottom Feed	308/013	463



Machine and Engine Details			ENGINE END DETAILS							JET BLOCK		Jet Size	Throttle Valve	Needle Position	Needle Jet	Float Chbr. Type No.	Float Chbr. Body Part No.	Spare Parts List No.
			Capacity	Model	Year	Carburettor Type No.	Mix. Chbr. Body No.	Internal Bore	Centre Line of Body to Face of Fl'ge	Flange Centres	Dia. of Bolt Holes							
<b>AUTO MINOR.</b>																		
49 C.C.	Bicycle Power Unit ..	1952	308/13	308/006	.312"	1/2" dia.	Clip	Fitting		—	—	25	3	3	.0745	Top Feed	308/067	463
<b>BANTAMO TO.</b>																		
40 2-STROKE	Bicycle Power Unit ..	1950-52	308/15	308/003	.39"	1/2" dia.	Clip	Fitting		—	—	27	2	3	.0745	Bottom Feed	308/013	463
<b>BERINI.</b>	<b>(Pluvier).</b>																	
36 2-STROKE	Berini .. .. .	1950-53	308/1	308/001	.39"	1/2" dia.	Clip	Fitting		—	—	32	4	3	.0745	Bottom Feed	308/013	463
<b>B.S.A.</b>																		
249 S.V.	C10 (Ex W.D.) .. ..	1940-45	274D/3A	274/024R	3/32"	1 1/2"	2"	1 1/2"	3/32"	204/059R	25	90	4/4	3	Std.	3A	62/025	440
350 O.H.V.	B29 (Ex W.D.) .. ..	1940-45	76P/1BB	76/014	1"	1 1/2"	2"	1 1/2"	1"	6/058	45	160	6/4	3	Std.	1BB (7° & 3°)	64/282	440
350 O.H.V.	B30 (Ex W.D.) .. ..	1940-45	276C/1B	276/014R	1"	1 1/2"	2"	1 1/2"	1"	206/058R	45	170	6/4	2	Std.	1B	64/156B	440
496 S.V.	M20 (Ex W.D.) .. ..	1940-45	276L/1E	276/014R	1"	1 1/2"	2"	1 1/2"	1"	206/058R	45	170	6/4	2	Std.	1E	64/154	440
496 S.V.	M20 (Ex W.D.) .. ..	1940-45	276C/1B	276/014R	1"	1 1/2"	2"	1 1/2"	1"	206/058R	45	170	6/4	2	Std.	1B	64/156B	440
591 S.V.	M21 (Ex W.D.) .. ..	1940-45	276P/1B	276/024R	1 1/16"	1 1/2"	2"	1 1/2"	1 1/16"	206/059R	51	160	6/4	2	Std.	1B	64/156B	440
35 C.C.	Winged Wheel ... ..	1953-54	335/1	335/001	.390	1/2" dia.	Clip	Fitting		—	—	30	3	3	.0745	Combined with	Mix. Chr.	491
123 2-STROKE	D1 Bantam .. .. .	1947-50	261/001D	261/001	5/8"	1" dia.	Clip	Fitting		—	—	75	5	2	.106	Combined with	Mix. Chr.	465
123 2-STROKE	D1 Bantam .. .. .	1951-53	361/1	361/085D	5/8"	1" dia.	Clip	Fitting		—	—	75	5	2	.106	Combined with	Mix. Chr.	465
123 2-STROKE	D1 Bantam .. .. .	1954	361/8	361/085D	5/8"	1" dia.	Clip	Fitting		—	—	75	5	2	.106	Combined with	Mix. Chr.	465
123 2-STROKE	D1 Bantam (Competition)	1951-53	361/2	361/085D	5/8"	1" dia.	Clip	Fitting		—	—	75	5	2	.106	Combined with	Mix. Chr.	465
123 2-STROKE	D1 Bantam (Comp.) ..	1954	361/9	361/085D	5/8"	1" dia.	Clip	Fitting		—	—	75	5	2	.106	Combined with	Mix. Chr.	465
148 2-STROKE	D3 Bantam (Major) ..	1954	523/1	523/002	1 1/8"	1" dia.	Clip	Fitting		—	—	90	5	3	.107	Combined with	Mix. Chr.	453
148 2-STROKE	D3 Bantam Major (Comp.)	1954	523/2	523/002	1 1/8"	1" dia.	Clip	Fitting		—	—	90	5	3	.107	Combined with	Mix. Chr.	453
249 S.V.	C10 .. .. .	1946-53	274K/3A	274/024R	3/32"	1 1/2"	2"	1 1/2"	3/32"	204/059R	25	90	4/4	2	.105	3A	62/025	440
249 S.V.	C10L .. .. .	1954	274BT/3EG	274/024R	3/32"	1 1/2"	2"	1 1/2"	3/32"	204/059R	25	90	4/4	2	.105	3EG	22/025	440
249 O.H.V.	C11 .. .. .	1946-48	274L/1AT	274/400R	3/32"	1 1/2"	2"	1 1/2"	3/32"	204/059R	25	80	4/4	3	Std.	1AT (7°)	64/192	440
249 O.H.V.	C11 .. .. .	1949-53	274AU/1DA	274/410R	3/32"	1 1/2"	2"	1 1/2"	3/32"	204/059R (LH)	25	80	4/4	3	Std.	1DA (7°)	64/195	440
249 O.H.V.	C11G .. .. .	1954	274BU/1EH	274/410R	3/32"	1 1/2"	2"	1 1/2"	3/32"	204/059R (LH)	25	80	4/4	3	Std.	1EH (7°)	64/195	440
348 O.H.V.	B31 .. .. .	1946-48	276AW/1BB	276/402R	1"	1 1/2"	2"	1 1/2"	1 1/16"	206/058R	45	150	6/4	3	Std.	1BB (7° & 3°)	64/282	440
348 O.H.V.	B31 .. .. .	1949-54	276DR/1AT	276/402R	1"	1 1/2"	2"	1 1/2"	1 1/16"	206/058R	45	150	6/4	3	Std.	1AT (7°)	64/192	440
348 O.H.V.	B32 .. .. .	1946-48	276AW/1BB	276/402R	1"	1 1/2"	2"	1 1/2"	1 1/16"	206/058R	45	150	6/4	3	Std.	1BB (7° & 3°)	64/282	440
348 O.H.V.	B32 .. .. .	1949-54	276DR/1AT	276/402R	1"	1 1/2"	2"	1 1/2"	1 1/16"	206/058R	45	150	6/4	3	Std.	1AT (7°)	64/192	440
348 O.H.V.	B32, Gold Star .. ..	1949-54	T10 TT9	175/045RR	1 1/16"	1 1/2"	2"	1 1/2"	1 1/16"	175/108D	—	320	7	4	.109	14/534 (7°)	14/225R	449
350 S.V.	C12 .. .. .	1949	276DM/1B	276/014R	1"	1 1/2"	2"	1 1/2"	1"	206/058R	45	150	6/4	2	Std.	1B	64/156B	440
350	Clubman's .. .. .	1953	T10RN	185/061RR	1 3/32"	1 1/2"	2"	1 1/2"	1 3/32"	185/107	1 3/32"	450	6	4	.109	302/17 (Remote)	302/015	452
350	Clubman's .. .. .	1954	T10GP	316/403	1 3/32"	1 1/2"	2"	1 1/2"	1 3/32"	316/190	1 3/32"	210	6	1	.109	302/17 (Remote)	302/015	470
350	Scrambles .. .. .	1954	10TT9	175/061RR	1 3/32"	1 1/2"	2"	1 1/2"	1 3/32"	175/101D	1 3/32"	350	7	3	.109	302/10 (15°)	302/001	449
499 O.H.V.	B33, B34 .. .. .	1949-54	289G/1AT	289/014R	1 1/8"	1 1/2"	2"	1 1/2"	1 1/8"	229/069R	58	200	29/4	3	Std.	1AT (7°)	64/192	440
499 O.H.V.	B33-34 (Swedish) ...	1953	289V/1AT	289/014R	1 1/8"	1 1/2"	2"	1 1/2"	1 1/8"	229/069R	58	190	29/3	2	Std.	1AT (7°)	64/192	440
499 O.H.V.	B34, Gold Star .. ..	1949-54	T10 TT9	175/047RR	1 3/32"	1 1/2"	2"	1 1/2"	1 3/32"	175/101D	—	360	6	4	.109	14/534 (7°)	14/225R	449
499 O.H.V.	M33 .. .. .	1949-54	289G/1AT	289/014R	1 1/8"	1 1/2"	2"	1 1/2"	1 1/8"	229/069R	58	200	29/4	3	Std.	1AT (7°)	64/192	440
496 S.V.	M20 .. .. .	1946-54	276C/1B	276/014R	1"	1 1/2"	2"	1 1/2"	1"	206/058R	45	170	6/4	3	Std.	1B	64/156B	440
500	Clubman's .. .. .	1953	T10RN	185/048RR	1 3/16"	1 1/2"	2"	1 1/2"	1 3/16"	185/295	1 3/16"	520	7	4	.109	302/17 (Remote)	302/015	452
500	Clubman's .. .. .	1954	T10GP	316/255	1 3/16"	1 1/2"	2"	1 1/2"	1 3/16"	316/401	1 3/16"	260	7	2	.109	302/17 (Remote)	302/015	470



Machine and Engine Details			Carburettor Type No.	Mix. Chbr. Body No.	Internal Bore	ENGINE END DETAILS				JET BLOCK		Jet Size	Throttle Valve	Needle Position	Needle Jet	Float Chbr. Type No.	Float Chbr. Body Part No.	Spare Parts List No.
						Centre Line of Body to Face of Fl'ge	Flange Centres	Dia. of Bolt Holes	Dia. at Engine End	Part No.	Size No.							
Capacity	Model	Year																
B.S.A.—continued																		
500	Scrambles .. ..	1954	10TT9	175/047RR	1 5/16"	1 1/2"	2"	1 1/2"	1 5/16"	175/101D	1 5/16"	360	7	4	-109	302/10 (7°)	302/001	449
497 O.H.V.	A7, Twin .. ..	1946-47	276CG/1A	276/417R	1 1/8"	1 1/2"	2"	1 1/2"	1 1/8"	206/057R	39	140	6/3	3	-107	1A	64/156	440
497 O.H.V.	A7, Twin .. ..	1947-48	276CY/1A	276/417R	1 1/8"	1 1/2"	2"	1 1/2"	1 1/8"	206/057R	39	140	6/3	3	-107	1A	64/156	440
497 O.H.V.	A7, Twin .. ..	1949	276DP/1A	276/424R	1 1/8"	1 1/2"	2"	1 1/2"	1 1/8"	206/057R (LH)	39	140	6/3	3	-107	1A	64/156	440
497 O.H.V.	A7, Twin .. ..	1950	276EC/1B	276/424R	1 1/8"	1 1/2"	2"	1 1/2"	1 1/8"	206/057R (LH)	39	140	6/3	3	-107	1B	64/156B	440
497 O.H.V.	A7, Twin .. ..	1951-53	276EU/1DB	276/424R	1 1/8"	1 1/2"	2"	1 1/2"	1 1/8"	206/057R (LH)	39	140	6/4	3	-107	1DB	64/195B	440
497 O.H.V.	A7, Star Twin (L.H. Carb.)	1949	275AR/1A	275/409R	7/8"	1 1/2"	2"	1 1/2"	.920"	205/058R (LH)	33	110	5/4	3	-107	1A	64/156	440
	(R.H. Carb.)	1949	275AS/1A	275/410R	7/8"	1 1/2"	2"	1 1/2"	.920"	205/058R	33	110	5/4	3	-107	1A	64/156	440
497 O.H.V.	A7, Star Twin (L.H. Carb.)	1950	275BA/1F	275/409R	7/8"	1 1/2"	2"	1 1/2"	.920"	205/058R (LH)	33	110	5/4	3	-107	1F	64/154B	440
	(R.H. Carb.)	1950	275BB/1F	275/410R	7/8"	1 1/2"	2"	1 1/2"	.920"	205/058R	33	110	5/4	3	-107	1F	64/154B	440
497 O.H.V.	A7, Star Twin .. ..	1951-53	276FD/1DB	276/431R	1"	1 1/2"	2"	1 1/2"	1 1/8"	206/058R (LH)	45	160	6/4	3	-107	1DB	64/195B	440
497 O.H.V.	A7, Star Twin .. ..	1952-54	T10 TT9	175/346	1 1/8"	1 1/2"	2"	1 1/2"	1 1/8"	175/352	1 1/8"	350	6	4	-109	14/533	14/225R	449
497 O.H.V.	A7 Shooting Star ..	1954	276GK/1BS	276/431R	1"	1 1/2"	2"	1 1/2"	1 1/8"	206/058R (LH)	45	170	6/4	3	-107	1BS (15°)	64/354B	440
591 S.V.	M21 .. ..	1946-54	276BR/1B	276/024R	1 1/8"	1 1/2"	2"	1 1/2"	1 1/8"	206/059R	51	160	6/4	2	Std.	1B	64/156B	440
596 S.V.	For "A.A." only ..	1949-53	276DZ/1B	276/130R	1 1/8"	2 1/2"	2"	1 1/2"	1 1/8"	206/059R	51	160	6/4	2	Std.	1B	64/156B	440
646 O.H.V.	A10, Twin, Golden Flash	1950-53	276ER/1DB	276/427R	1 1/8"	1 1/2"	2"	1 1/2"	1 1/8"	206/059R (LH)	51	170	6/4	2	-108	1DB	64/195B	440
646 O.H.V.	A10, Golden Flash ..	1954	276GG/1DB	276/427R	1 1/8"	1 1/2"	2"	1 1/2"	1 1/8"	206/059R (LH)	51	170	6/4	2	-107	1DB (7°)	64/195	440
646 O.H.V.	A10, Road Rocket ..	1954	10TT9	175/346RR	1 1/8"	1 1/2"	2"	1 1/2"	1 1/8"	175/352	1 1/8"	340	6	4	-109	14/532 (15°)	14/225R	449
<b>BUSY BEE</b>	.. ..	1951-52	308/2	308/003	.312"	1/2" dia.	Clip	Fitting		—	—	27	2	3	-078	Bottom Feed	308/013	463
<b>CONDOR.</b>																		
350 S.V.	.. ..	1947	274AR/3A	274/022R	3/8"	1" dia.	Clip	Fitting		204/059R	25	90	4/4	3	Std.	3A	62/025	440
500 O.H.V.	.. ..	1937-52	276FL/1BH	276/011R	1"	1 1/8" dia.	Clip	Fitting		206/058R	45	150	6/4	3	Std.	1BH (Hor)	64/177	440
850 TWIN	.. ..	1946-52	275AE/2A	275/012R	7/8"	1 1/8" dia.	Clip	Fitting		205/058R	33	100	5/3	3	Std.	2A	64/163	440
<b>CORGI.</b>																		
98 2-STROKE	.. ..	1946-50	259/001B	259/001B	.425"	3/4" dia.	Clip	Fitting		—	—	55	3	2	-107	Combined with Mix. Chr.		464
98 2-STROKE	.. ..	1951-54	359/001D	359/001D	.425"	3/4" dia.	Clip	Fitting		—	—	45	3	3	-109	Combined with Mix. Chr.		464
<b>CYC AUTO.</b>																		
98 2-STROKE	Superior .. ..	1950-54	359/001B	359/056	.425"	3/4" dia.	Clip	Fitting		—	—	55	3	3	-107	Combined with Mix. Chr.		464
<b>CYCLAID.</b>																		
31 2-STROKE	Bicycle Power Unit ..	1950-54	308/5	308/002	.39"	1/2" dia.	Clip	Fitting		—	—	25	2	3	-078	Bottom Feed	308/013	463
<b>CYCLEMASTER.</b>																		
25 2-STROKE	Bicycle Power Unit (Black Cable) ..	1950-52	308/11	308/001	.39"	1/2" dia.	Clip	Fitting		—	—	30	2	3	-0745	Bottom Feed	308/013	463
25 2-STROKE	Bicycle Power Unit (Silver Cable) ..	1950-52	308/11	308/001	.39"	1/2" dia.	Clip	Fitting		—	—	35	2	3	-0745	Bottom Feed	308/013	463
<b>CYMOTA.</b>																		
45 2-STROKE	Bicycle Power Unit ..	1950-52	308/12	308/009	.312"	1/2" dia.	Clip	Fitting		—	—	25	2	1	-078	Bottom Feed	308/013	463

Machine and Engine Details			ENGINE END DETAILS						JET BLOCK		Jet Size	Throttle Valve	Needle Position	Needle Jet	Float Chbr. Type No.	Float Chbr. Body Part No.	Spare Parts List No.	
			Carburettor Type No.	Mix. Chbr. Body No.	Internal Bore	Centre Line of Body to Face of Fl'ge	Flange Centres	Dia. of Bolt Holes	Dia. at Engine End	Part No.								Size No.
Capacity	Model	Year																
<b>DIESELLA.</b>																		
49 2-STROKE	.. .. .	1950-52	308/15	308/003	.39"	1/2" dia.	Clip	Fitting	—	—	32	2	3	.078	Top Feed	—	463	
49 2-STROKE	.. .. .	1950-52	352/235D	352/235D	.475"	3/4" dia.	Clip	Fitting	—	—	15P 30M	3	—	—	Combined with	Mix. Chr.	—	
<b>DOUGLAS.</b>																		
125 2-STROKE	Vespa .. .. .	1951-52	361/200	361/070	3/16"	1" dia.	Clip	Fitting	—	—	80	3	3	.105	Combined with	Mix. Chr.	465	
125 2-STROKE	Vespa .. .. .	1952-53	361/200-2	361/070	3/16"	1" dia.	Clip	Fitting	—	—	80	3	3	.086	Combined with	Mix. Chr.	465	
348 O.H.V.	Mark III } (L.H. Carb.)	1947-54	274AK/4A	274/408R	3/16"	1 1/2"	1.56"	3/32"	3/4"	204/058R(LH)	21	80	4/5	3	.107	4A	62/028	440
348 O.H.V.	Sports } (R.H. Carb.)		274AJ/4A	274/407R	3/16"	1 1/2"	1.56"	3/32"	3/4"	204/058R	21	80	4/5	3	.107	4A	62/028	440
348 O.H.V.	90 Plus } (L.H. Carb.)	1947-54	276EN/2DX	276/104R	3/16"	1 1/2" dia.	Clip	Fitting	206/503R	39	130	6/3	2	Std.	2DX	64/176	440	
348 O.H.V.	90 Plus } (R.H. Carb.)	1947-54	276EM/2DX	276/001R	3/16"	1 1/2" dia.	Clip	Fitting	206/502R	39	130	6/3	2	Std.	2DX	64/176	440	
348 O.H.V.	80 Plus } (L.H. Carb.)	1951-54	276EQ/1B	276/104R	3/16"	1 1/2" dia.	Clip	Fitting	206/503R	39	130	6/3	2	Std.	1B	64/156B	440	
348 O.H.V.	80 Plus } (R.H. Carb.)	1951-54	276EP/1B	276/001R	3/16"	1 1/2" dia.	Clip	Fitting	206/502R	39	130	6/3	2	Std.	1B	64/156B	440	
348 O.H.V.	Competition .. .. .	1950-52	T15 TT9	—	3/16"	1 1/2" dia.	Clip	Fitting	—	—	240	6	4	.107	302/3	302/015	449	
125 2-STROKE	Vespa .. .. .	1954	561/1	561/001	.709"	1" dia.	Clip	Fitting	—	—	95	4	2	.086	Combined with	Mix. Chr.	465	
<b>DOT.</b>																		
197 2-STROKE	Standard .. .. .	1950-54	261/021D	261/021D	3/16"	1" dia.	Clip	Fitting	—	—	65	3	3	.107	Combined with	Mix. Chr.	465	
197 2-STROKE	De-Luxe .. .. .	1950-54	261/021D	261/021D	3/16"	1" dia.	Clip	Fitting	—	—	65	3	3	.107	Combined with	Mix. Chr.	465	
197 2-STROKE	Scrambler .. .. .	1950-54	261/021D	261/021D	3/16"	1" dia.	Clip	Fitting	—	—	65	3	3	.107	Combined with	Mix. Chr.	465	
250 S.V.	.. .. .	1951-54	274BE/3B	274/027R	3/16"	1 1/2"	1.574"	3/32"	3/16"	204/059R	25	90	4/4	2	Std.	3B	62/025	440
E.M.C. 346	2-STROKE "350" .. .. .	1947-54	289L/2BH	289/022R	1 3/16"	1 1/4" dia.	Clip	Fitting	229/070R	61	200	29/3	3	Std.	2BH	64/176	440	
<b>EXCELSIOR.</b>																		
98 2-STROKE	47/V1, 47/G2, S1 .. .. .	1947-54	259/001B	259/001B	.425"	3/4" dia.	Clip	Fitting	—	—	55	3	3	Std.	Combined with	Mix. Chr.	464	
100 2-STROKE	Minor .. .. .	1947-52	259/021D	259/021D	.531"	3/4" dia.	Clip	Fitting	—	—	70	5	2	.107	Combined with	Mix. Chr.	464	
125 2-STROKE	Minor, MK11 .. .. .	1949-52	261/001D	261/001D	3/8"	1" dia.	Clip	Fitting	—	—	75	3	3	.107	Combined with	Mix. Chr.	465	
150 2-STROKE	Minor .. .. .	1951-52	274BJ/4A	274/414R	3/32"	1 1/2"	2"	11/32"	3/16"	204/059R	25	80	4/5	2	Std.	4A	62/028	440
150 C.C.	Courier .. .. .	1953	275BO/2A	275/413R	3/8"	1 1/2"	2"	11/32"	7/16"	205/058R(LH)	33	90	5/4	3	Std.	2A	64/163	440
250 2-STROKE	Talisman } R.H. Carb.	1952-54	274BM	274/024R	3/32"	1 1/2"	2"	11/32"	3/16"	204/059R	25	80	4/4	2	Std.	302/14 Remote	302/015	440 and
	Twin } L.H. Carb.	1952-54	274BN	274/414R	3/32"	1 1/2"	2"	11/32"	3/16"	204/059R(LH)	25	80	4/4	2	Std.		302/015	449
250 2-STROKE	Talisman Twin, TT1 .. .. .	1950-54	274BF/4A	274/411R	3/32"	1 1/2"	2"	11/32"	3/16"	204/059R	25	80	4/5	2	Std.	4A	62/028	440
<b>F.N.</b>																		
250 O.H.V.	.. .. .	1946-52	275AC/1A	275/014R	7/8"	1 1/2"	2"	11/32"	7/8"	205/058R	33	110	5/5	2	.109	1A	64/156	440
250 O.H.V.	.. .. .	1953-54	275BP/1DQ	275/014R	7/8"	1 1/2"	2"	11/32"	7/8"	205/058R	33	100	5/4	3	Std.	1DQ	64/156B	440
350 S.V.	.. .. .	1946-52	274AG/3A	274/024R	3/32"	1 1/2"	2"	11/32"	3/16"	204/059R	25	95	4/5	3	Std.	3A	62/025	440
350 S.V.	.. .. .	1953-54	274BR/1DQ	274/024R	3/32"	1 1/2"	2"	11/32"	3/16"	204/059R	25	95	4/5	3	Std.	1DQ	64/156B	440
350 O.H.V.	} .. .. .	1950-52	276FK/1A	276/014R	1"	1 1/2"	2"	11/32"	1"	206/058R	45	130	6/5	3	Std.	1A	64/156	440
450 S.V.																		
450 O.H.V.																		
350 O.H.V. &																		
450 S.V. & O.H.V.	.. .. .	1953-54	276FS/1DQ	276/014R	1"	1 1/2"	2"	11/32"	1"	206/058R	45	130	6/5	3	Std.	1DQ	64/156B	440
450 S.V.	Army .. .. .	1950-52	276FC/1DY	276/150R	1"	1 1/2"	2"	11/32"	1"	206/058R	45	130	6/5	3	Std.	1DY	64/177B	440



1940 to 1954 (inclusive) SETTINGS AND SPARE PARTS LIST—continued

LIST No. 601/2  
(ISSUE NO. 2)

Machine and Engine Details			Carburettor Type No.	Mix. Chbr. Body No.	Internal Bore	ENGINE END DETAILS				JET BLOCK		Jet Size	Throttle Valve	Needle Position	Needle Jet	Float Chbr. Type No.	Float Chbr. Body Part No.	Spare Parts List No.
						Centre Line of Body to Face of Fl'ge	Flange Centres	Dia. of Bolt Holes	Dia. at Engine End	Part No.	Size No.							
Capacity	Model	Year																
<b>FRANCIS - BARNETT.</b>																		
125 C.C.	...	1951	205G/2A	205/117R	$\frac{7}{8}$ "	1 $\frac{1}{2}$ "	2"	$\frac{11}{16}$ "	$\frac{3}{8}$ "	205/058R(LH)	33	110	5/4	3	-107	2A	64/163	440
125 C.C.	Villiers	1953-54	276FZ/2BH	276/104R	$\frac{11}{16}$ "	1 $\frac{1}{2}$ "	Clip	Fitting		206/057R(LH)	39	110	6/3	3	-107	2BH	64/176	440
197 C.C.	Falcon	1950-51	276EV/2A	276/001R	$\frac{11}{16}$ "	1 $\frac{1}{2}$ " dia.	Clip	Fitting	$\frac{11}{16}$ "	206/057R	39	110	6/3	3	-107	2A	64/163	440
197 C.C.	Falcon	1952-54	276FO/2A	276/104R	$\frac{11}{16}$ "	1 $\frac{1}{2}$ " dia.	Clip	Fitting	$\frac{11}{16}$ "	206/057R(LH)	39	110	6/3	3	-107	2A	64/163	440
197 C.C.	Villiers	1953-54	276FY/2A	276/435R	$\frac{11}{16}$ "	1 $\frac{1}{2}$ "	Clip	Fitting		206/057R(LH)	39	110	6/3	3	-107	2A	64/163	440
197 C.C.	Villiers	1953-54	276GA/2A	276/145R	1"	1 $\frac{1}{2}$ "	Clip	Fitting		206/058R(LH)	45	130	6/3	3	-107	2A	64/163	440
<b>GILLET.</b>																		
100 2-STROKE	Ref. 70-140, VM	1946-54	359/015E	359/015E	-475"	$\frac{3}{4}$ " dia.	Clip	Fitting		—	—	55	2	2	-107	Combined with Mix. Chr.	464	
125 2-STROKE	Ref. 64-140	1946-53	359/025E	359/025E	-531"	$\frac{3}{4}$ " dia.	Clip	Fitting		—	—	70	2	3	-107	Combined with Mix. Chr.	464	
125 C.C.	Scgoter	1954	349/2	349/001	$\frac{1}{2}$ "	1" dia.	Clip	Fitting		—	—	90	3	2	-105	Combined with Mix. Chr.	—	
250 2-STROKE	..	1946-54	274AN/4J	274/022R	$\frac{31}{32}$ "	1" dia.	Clip	Fitting		204/059R	25	85	4/4	2	Std.	4J (15°)	62/032	440
250 O.H.V.	..	1947-54	274AO/3A	274/022R	$\frac{31}{32}$ "	1" dia.	Clip	Fitting		204/059R	25	85	4/3	2	Std.	3A	62/025	440
250 C.C.	Scooter	1954	275BS/1EJ	275/012R	$\frac{7}{8}$ "	1" dia.	Clip	Fitting		205/058R	33	110	5/4	2	Std.	1EJ	64/156	440
300 C.C.	Ref. 300/140	1952-54	274BQ/3A	274/022R	$\frac{31}{32}$ "	1" dia.	Clip	Fitting		204/059R	25	90	4/4	2	Std.	3A	62/025	440
350 2-STROKE	..	1947	275AK/1A	275/407R	$\frac{7}{8}$ "	1" dia.	Clip	Fitting		205/058R	33	110	5/4	3	Std.	1A	64/156	440
350 & 400 S.V.	Ref. 13095	1946	204C/3A	204/405R	$\frac{31}{32}$ "	1 $\frac{1}{2}$ "	2"	$\frac{11}{16}$ "	$\frac{7}{8}$ "	204/411R	25	75	4/4	2	Std.	3A	62/025	440
400 O.H.V.	..	1950-52	206H/1DR	206/140R/S	$\frac{11}{16}$ "	1 $\frac{1}{2}$ "	2"	$\frac{11}{16}$ "	$\frac{11}{16}$ "	206/057R	39	150	6/4	3	Std.	1DR	64/177B	440
500 O.H.V.	Ref. 475/123	1950-53	206G/1DR	206/157R/S	1 $\frac{1}{16}$ "	1 $\frac{1}{2}$ "	2"	$\frac{11}{16}$ "	1 $\frac{1}{16}$ "	206/059R	51	170	6/4	3	Std.	1DR	64/177B	440
500 O.H.V.	Ref. 19/123	1946	276BH/1J	276/024R	1 $\frac{1}{16}$ "	1 $\frac{1}{2}$ "	2"	$\frac{11}{16}$ "	1 $\frac{1}{16}$ "	206/059R	51	170	6/4	2	Std.	1J (15°)	64/186	440
500 S	Ref. 450/123	1949-52	276EJ/1B	276/004R	$\frac{11}{16}$ "	1 $\frac{1}{2}$ "	2"	$\frac{11}{16}$ "	$\frac{11}{16}$ "	206/057R	39	130	6/3	3	Std.	1B	64/156B	440
500 S	Army	1951-53	276EO/1B	276/004R	$\frac{11}{16}$ "	1 $\frac{1}{2}$ "	2"	$\frac{11}{16}$ "	$\frac{11}{16}$ "	206/057R	39	140	6/4	2	Std.	1B	64/156B	440
<b>HUSQVARNA.</b>																		
100 2-STROKE	..	1946-50	359/021D	359/021D	-531"	$\frac{3}{4}$ " dia.	Clip	Fitting		—	—	55	3	5	-107	Combined with Mix. Chr.	464	
120 2-STROKE	..	1950-54	361/001D	361/001D	$\frac{7}{8}$ "	1" dia.	Clip	Fitting		—	—	65	3	5	-107	Combined with Mix. Chr.	465	
175 2-STROKE	..	1952-54	274BP/4EA	274/415R	$\frac{31}{32}$ "	1" dia.	Clip	Fitting		204/058R	21	80	4/4	3	-105	4EA	62/200	440
<b>INDIAN.</b>																		
98 2-STROKE	Papoose	1950-52	259/001B	259/001B	-425"	$\frac{3}{4}$ " dia.	Clip	Fitting		—	—	55	3	2	-107	Combined with Mix. Chr.	464	
248 S.V.	Brave	1950-54	274BE/3B	274/027R	$\frac{31}{32}$ "	1 $\frac{1}{2}$ "	1-574"	$\frac{3}{32}$ "	$\frac{31}{32}$ "	204/059R	25	90	4/4	2	Std.	3B	62/025	440
430 C.C.	Vertical Twin	1949	275AU/1A	275/411R	$\frac{7}{8}$ "	1" dia.	Clip	Fitting		205/058R	33	130	5/3	3	-107	1A	64/156	440
498 O.H.V.	Warrior and TT	1950-54	276ES/1B	276/428R	$\frac{11}{16}$ "	1 $\frac{1}{2}$ " dia.	Clip	Fitting		206/057R	39	160	6/3 $\frac{1}{2}$	3	-107	1B	64/156B	440
1308 C.C.	Chief 352	1952	289R/1A	289/034R	1 $\frac{3}{16}$ "	1 $\frac{1}{2}$ "	2"	$\frac{11}{16}$ "	1 $\frac{3}{16}$ "	229/071R	65	240	29/3	3	Std.	1A	64/156	440
500 C.C.	Twin	1953-54	275BE/1B	275/011R	$\frac{7}{8}$ "	1"	Clip	Fitting		205/058R	33	130	5/3	3	-107	1B	64/156B	440
<b>J.A.P.</b>																		
350	Dirt Track	1947-54	27/002	27/002	1 $\frac{1}{16}$ "	1 $\frac{1}{4}$ " dia.	Clip	Fitting		27/068	—	700	12	—	—	14/603	14/603	451
500	Dirt Track	1947-54	27/013	27/013	1 $\frac{1}{8}$ "	1 $\frac{3}{8}$ " dia.	Clip	Fitting		27/069	—	860	12	—	—	14/603	14/603	451
<b>J.B. (SWEDEN).</b>																		
50 2-STROKE	Moped	1953-54	308/1	308/001	-39	$\frac{1}{2}$ " dia.	Clip	Fitting		—	—	32	4	4	-0745	Bottom Feed	308/013	463
150 2-STROKE	..	1948-53	223/001C	223/001	$\frac{11}{16}$ "	1" dia.	Clip	Fitting		—	—	90	5	3	-107	Combined with Mix. Chr.	453	
150 2-STROKE	..	1954	523/001C	523/001	$\frac{11}{16}$ "	1" dia.	Clip	Fitting		—	—	90	5	3	-107	Combined with Mix. Chr.	453	
150 2-STROKE	Sport	1954	275BV/2EN	275/004R	$\frac{11}{16}$ "	1 $\frac{1}{2}$ "	2"	$\frac{11}{16}$ "	$\frac{11}{16}$ "	205/057R	28	90	5/4	3	Std.	2EN	64/176	440



Machine and Engine Details			Carburetter Type No.	Mix. Chbr. Body No.	Internal Bore	ENGINE END DETAILS				JET BLOCK		Jet Size	Throttle Valve	Needle Position	Needle Jet	Float Chbr. Type No.	Float Chbr. Body Part No.	Spare Parts List No.
						Centre Line of Body to Face of Fl'ge	Flange Centres	Dia. of Bolt Holes	Dia. at Engine End	Part No.	Size No.							
Capacity	Model	Year																
<b>MAGNEET.</b>																		
50 c.c.	Poulain ... ..	1952-53	308/10	308/002	.39"	½" dia.	Clip	Fitting			32	3	3	.078"	Top Feed	308/012	463	
<b>MATCHLESS.</b>																		
347 O.H.V.	G3 (Ex W.D.) .. ..	1940-45	276B/1J	276/400R	1"	1½"	2"	11/16"	1"	206/400R	45	150	6/4	3	Std.	1J (15°)	64/186	440
347 O.H.V.	G3L (Ex W.D.) .. ..	1940-45	275F/1J	275/402R	½"	1½"	2"	11/16"	1"	275/403	33	160	5/5	4	Std.	1J (15°)	64/186	440
347 O.H.V.	G3C, G3L, G3LS ..	1946-50	76D/1J	76/014	1"	1½"	2"	11/16"	1"	6/058	45	150	6/4	3	Std.	1J (15°)	64/186	440
347 O.H.V.	G3C, G3L, G3LS ..	1951-53	76AE/1AK	76/014	1"	1½"	2"	11/16"	1"	6/058	45	150	6/4	3	Std.	1AK (3°)	64/303	440
347 O.H.V. c.c.	G3L, G3L/S, G3L/C, G3L/CS .. ..	1954	76AV/1ED	76/024	1 1/16"	1½"	2"	11/16"	1 1/16"	6/059	51	150	6/4	3	Std.	1ED (3°)	64/303B	440
498 O.H.V.	G80, G80C, G80S, G9 ..	1946-53	89B/1AK	89/403	1 3/32"	1½"	2"	11/16"	1 3/32"	29/068	54	180	29/4	3	Std.	1AK (3°)	64/303	440
498 O.H.V.	G80, G80S, G80/C, G80/CS	1954	89N/1ED	89/405	1 5/32"	1½"	2"	11/16"	1 5/32"	29/070	61	180	29/4	2	Std.	1ED (3°)	64/303B	440
498 O.H.V.	G9 .. ..	1951-53	76AG/1AU	76/412	1"	1½"	2"	11/16"	1"	6/058	45	180	6/4	3	Std.	1AU (7°)	64/192B	440
498 O.H.V.	Twin G9 .. ..	1954	76AT/1EF	76/412	1"	1½"	2"	11/16"	1"	6/058	45	180	6/4	3	Std.	1EF (7°)	64/192B	440
347	G3LCS (Scrambles) ..	1954	10TT9	175/389RR	1 1/16"	1 3/4"	2"	11/16"	1 1/16"	175/108D	1 1/16"	300	5	4	.109	302/10	302/001	449
498	Twin Racing .. ..	1954	10TT9	175/048RR	1 3/16"	1 3/4"	2"	11/16"	1 3/16"	175/101D	1 3/16"	340	7	4	.109	302/10	302/001	449
<b>MOCYC.</b>																		
49 2-STROKE	Bicycle Power Unit ..	1951-52	308/16	308/002	.39"	½" dia.	Clip	Fitting			27	2	3	.078	Top Feed	308/012	463	
<b>MOTAMITE.</b>																		
49 2-STROKE	Bicycle Power Unit ..	1950-52	308/10	308/002	.39"	½" dia.	Clip	Fitting			27	2	3	.078	Top Feed	308/012	463	
49 2-STROKE	Bicycle Power Unit ..	1950-52	259/088	259/088	11/16"	¾" dia.	Clip	Fitting			35	2	2	.107	Combined with Mix. Chr.		464	
<b>MOTOSACOCHE.</b>																		
150-170 2-STR	Ref. 9022-164 .. ..	1946-52	95/3	95/055	11/16"	1" dia.	Clip	Fitting			25P 40M				Concentric	95/002	468	
150-175 2-STR	Ref. 9022-142 .. ..	1946-52	95/5	95/055	11/16"	1" dia.	Clip	Fitting			20P 40M				Concentric	95/002	468	
150-175 2-STR	Ref. 9022-143 .. ..	1946-52	95/3	95/055	11/16"	1" dia.	Clip	Fitting			20P 40M				Concentric	95/002	468	
250 2-STROKE	Ref. 9022-140, 9022-160	1946-52	244/386LS	244/386	11/16"	1 3/4"	2"	11/16"	7/8"			35P 65M			Concentric	15/1699	468	
250 2-STROKE	Ref. 9022-141 .. ..	1946-52	244/378	244/378	11/16"	1 3/4"	2"	11/16"	7/8"			35P 65M			Concentric	15/1699	468	
285 2-STROKE	Ref. 9022-154 .. ..	1946-52	244/386LS	244/386	11/16"	1 3/4"	2"	11/16"	7/8"			40P 65M			Concentric	15/1699	468	
285 2-STROKE	Ref. 9022-155 .. ..	1946-52	244/378	244/378	11/16"	1 3/4"	2"	11/16"	7/8"			40P 65M			Concentric	15/1699	468	
300 4-STROKE	.. ..	1946-52	244/423	244/423	11/16"	1 1/8" dia.	Clip	Fitting			25P 60M				Concentric	15/1699	468	
350 O.H.V.	Ref. 9022-1 .. ..	1946-52	276BD/1A	276/001R	11/16"	1 1/8" dia.	Clip	Fitting		206/057R	39	130	6/4	3	Std.	1A	64/156	440
350 2-STROKE	Ref. 9022-156 .. ..	1946-52	244/386LS	244/386	11/16"	1 3/4"	2"	11/16"	7/8"			35P 70M			Concentric	15/1699	468	
350 2-STROKE	Ref. 9022-157 .. ..	1946-52	244/378	244/378	11/16"	1 3/4"	2"	11/16"	7/8"			35P 70M			Concentric	15/1699	468	
500 O.H.V.	Ref. 9022-3 .. ..	1946-52	276BF/1A	276/011R	1"	1 1/8" dia.	Clip	Fitting		206/058R	45	150	6/4	3	Std.	1A	64/156	440
500 O.H.V.	Ref. 9022-52 .. ..	1946-52	276BG/1BH	276/011R	1"	1 1/8" dia.	Clip	Fitting		206/058R	45	150	6/4	3	Std.	1BH (HZ)	64/177	440
<b>NORMAN</b>																		
197 c.c.	Villiers .. ..	1952-54	276FR/2A	276/001R	11/16"	1 1/8" dia.	Clip	Fitting		206/057R	39	110	6/3	3	.107	2A	64/163	440



1940 to 1954 (inclusive) SETTINGS AND SPARE PARTS LIST—continued

LIST No. 601/2  
(ISSUE NO. 2)

Machine and Engine Details			ENGINE END DETAILS							JET BLOCK		Jet Size	Throttle Valve	Needle Position	Needle Jet	Float Chbr. Type No.	Float Chbr. Body Part No.	Spare Parts List No.
			Carburettor Type No.	Mix. Chbr. Body No.	Internal Bore	Centre Line of Body to Face of Fl'ge	Flange Centres	Dia. of Bolt Holes	Dia. at Engine End	Part No.	Size No.							
Capacity	Model	Year																
<b>NORTON.</b>																		
490 S.V.	16H (Ex W.D.) .. ..	1940-45	276AE/1BE	276/406	1"	1 1/8" dia.	Clip	Fitting		206/058	45	170	6/4	2	Std.	1BE	64/156B	440
348 O.H.V.	350 Trials .. ..	1946-49	276CP/1D	276/012V	1"	1 1/8" dia.	Clip	Fitting		206/058	45	170	6/4	3	Std.	1D	64/156B	440
348 O.H.C.	40 .. ..	1946-54	T10TT	175/060	1 3/32"	2 1/8"	2"	2 1/4"	1 3/32"	175/101D	—	350	6	4	-109	14/064 (15°)	14/314	441R
348 O.H.C.	40M .. ..	1946-50	T10RN	185/060	1 3/32"	2 1/8"	2"	2 1/4"	1 3/32"	185/107D	—	500	6	5	-109	302/1	302/001	417 & 449
348 O.H.C.	40M .. ..	1951	10RN9	185/060	1 3/32"	2 1/8"	2"	2 1/4"	1 3/32"	185/107D	—	500	6	5	-109	302/8	302/015	452
340 O.H.C.	40M .. ..	1952-54	T10GP	316/092	1 1/8"	2 1/8"	2"	2 1/4"	1 1/8"	316/109	1 5/32"	230	5	3	-109	302/8	302/015	470
348 O.H.V.	50 and 55 .. ..	1946-49	276CP/1D	276/012V	1"	1 1/8" dia.	Clip	Fitting		206/058	45	170	6/4	3	Std.	1D	64/156B	440
490 S.V.	16H .. ..	1946-54	276AT/1BE	276/408V	1"	1 1/8" dia.	Clip	Fitting		206/058	45	160	6/5	3	Std.	1BE	64/156B	440
490 S.V.	16H .. ..	1953-54	276FU/1DJ	276/408V	1"	1 1/8" dia.	Clip	Fitting		206/058	45	160	6/5	3	Std.	1DJ	64/156B	440
490 O.H.V.	18, ES2, 500 Trials ..	1946-54	276AU/1BE	276/407V	1 1/16"	1 1/4" dia.	Clip	Fitting		206/059	51	160	6/4	3	Std.	1BE	64/156B	440
490 O.H.V.	18 .. ..	1953-54	276FT/1DJ	276/407	1 1/16"	1 1/4" dia.	Clip	Fitting		206/059	51	160	6/4	3	Std.	1DJ	64/156B	440
490 O.H.C.	30 .. ..	1946-54	T10TT	175/043	1 3/32"	2 1/8"	2"	2 1/4"	1 3/16"	175/101D	—	350	7	2	-109	14/064 (15°)	14/314	441R
490 O.H.C.	30M .. ..	1946-50	T10RN	185/281	1 3/16"	2 1/8"	2"	2 1/4"	1 1/4"	185/107	—	560	6	4	-109	302/1	302/001	417 & 449
490 O.H.C.	30M .. ..	1951	10RN9	185/281RR	1 3/16"	2 1/8"	2"	2 1/4"	1 1/4"	185/295R	—	560	6	4	-109	302/8	302/015	452
490 O.H.C.	30M .. ..	1952	T10GP	316/095	1 3/32"	2 1/8"	2"	2 1/4"	1 1/4"	316/147	1 3/32"	260	5	3	-109	302/8	302/015	470
490 C.C.	30M .. ..	1953-54	T5GP		1 3/32"	2 1/8"	65 m/m		1 3/32"		1 3/32"	370	5	3	-109	302/17		
490 O.H.V.	18 Special .. ..	1949-54	276DS/1DW	276/407	1 1/16"	1 1/4" dia.	Clip	Fitting		206/059	51	160	6/4	3	Std.	1DW	64/156B	440
497 O.H.V.	7 Twin "Dominator" ..	1949-54	76AK/1AT	76/413	1"	1 1/8"	2"	1 1/8"	1 1/8"	6/058	45	170	6/3 1/2	2	-107	1AT (7°)	64/192	440
596 S.V.	No. 1 "Big Four" ..	1946-49	276AT/1BE	276/408V	1"	1 1/8" dia.	Clip	Fitting		206/058	45	160	6/5	3	Std.	1BE	64/156B	440
596 S.V.	No. 1 "Big Four" ..	1950-52	276ED/1BE	276/408V	1"	1 1/8" dia.	Clip	Fitting		206/058	45	170	6/4	3	Std.	1BE	64/156B	440
600 S.V.	Big 4 .. ..	1953-54	276FV/1DJ	276/011	1"	1 1/8"	Clip	Fitting		206/058	45	170	6/4	3	Std.	1DJ	64/156B	440
<b>PANTHER (P. &amp; M.)</b>																		
248 O.H.V.	60 .. ..	1946-49	274J/3J	274/027R	3/8"	1 1/2"	1.574"	3/8"	3/8"	204/059R	25	90	4/5	3	Std.	3J (15°)	62/032	440
248 O.H.V.	65 .. ..	1947-49	274AS/3A	274/027R	3/8"	1 1/2"	1.574"	3/8"	3/8"	204/059R	25	90	4/5	3	Std.	3A	62/025	440
248 O.H.V.	65 .. ..	1950-54	274BB/3A	274/024R	3/8"	1 1/2"	2"	1 1/8"	3/8"	204/059R	25	90	4/5	3	Std.	3A	62/025	440
248 O.H.V.	"Stroud" Mark II, 250	1950-52	274BC/1C	274/024R	3/8"	1 1/2"	2"	1 1/8"	3/8"	204/059R	25	90	4/5	3	Std.	1C	64/156B	440
348 O.H.V.	70 .. ..	1946-49	275P/1J	275/158R	7/8"	1 1/2"	1.574"	7/8"	7/8"	205/058R	33	110	5/4	3	Std.	1J (15°)	64/186	440
348 O.H.V.	75 .. ..	1947-49	275AN/1A	275/158R	7/8"	1 1/2"	1.574"	7/8"	7/8"	205/058R	33	110	5/4	3	Std.	1A	64/156	440
348 O.H.V.	75 .. ..	1950-54	275BC/1A	275/014R	7/8"	1 1/2"	2"	1 1/8"	7/8"	205/058R	33	110	5/4	3	Std.	1A	64/156	440
348 O.H.V.	"Stroud" Mark II, 350	1950-52	275BD/1C	275/014R	7/8"	1 1/2"	2"	1 1/8"	7/8"	205/058R	33	110	5/4	3	Std.	1C	64/156B	440
350 O.H.V.	"Stroud" .. ..	1953	276FW/1B	276/014R	1"	1 1/2"	2"	1 1/8"	1"	206/058R	45	150	6/3	3	Std.	1B	64/156B	440
350 O.H.V.	"Stroud" .. ..	1954	276GL/1A	276/014R	1"	1 1/2"	2"	1 1/8"	1"	206/058R	45	160	6/4	3	Std.	1A	64/156	440
598 O.H.V.	100 .. ..	1946-50	289C/1A	289/402R	1 1/8"	1 1/2"	2"	3/8"	1 1/8"	229/069R	58	220	29/3	3	Std.	1A	64/156	440
598 O.H.V.	100 .. ..	1951-53	289Q/1C	289/402R	1 1/8"	1 1/2"	2"	3/8"	1 1/8"	229/069R	58	220	29/3	3	Std.	1C	64/156B	440
598 O.H.V.	100 .. ..	1954	289Y/1C	289/408R	1 1/8"	1 1/2"	2"	3/8"	1 1/8"	229/069R	58	220	29/4	3	Std.	1C	64/156B	440
<b>POVAZSKE</b>																		
100 2-STROKE	.. ..	1950-52	261/001D	261/001D	5/8"	7/8" dia.	Clip	Fitting		—	—	65	3	3	-107	Combined with Mix. Chr.		465
<b>POWER PAK.</b>																		
47 2-STROKE	.. ..	1953-54	359/1	359/091D	.425"	3/4" dia.	Clip	Fitting		—	—	45	5	2	-106	Combined with Mix. Chr.		464
47 2-STROKE	Synchromatic Drive ..	1953-54	359/3	359/091D	.425"	3/4" dia.	Clip	Fitting		—	—	45	5	3	-106	Combined with Mix. Chr.		464
49 2-STROKE	Bicycle Power Unit ..	1950-52	359/091D	359/091D	.425"	3/4" dia.	Clip	Fitting		—	—	45	5	3	-106	Combined with Mix. Chr.		464



Machine and Engine Details				ENGINE END DETAILS						JET BLOCK		Jet Size	Throttle Valve	Needle Position	Needle Jet	Float Chbr. Type No.	Float Chbr. Body Part No.	Spare Parts List No.
				Carburettor Type No.	Mix. Chbr. Body No.	Internal Bore	Centre Line of Body to Face of Fl'ge	Flange Centres	Dia. of Bolt Holes	Dia. at Engine End	Part No.							
Capacity	Model	Year																
PUCH.	Ref. 250 .. .. .	1949-54	289P/2A	289/405R	1 $\frac{3}{8}$ "	35 mm.	Clip	Fitting		229/071R	65	200	29/3	3	Std.	2A	64/163	440
<b>ROYAL ENFIELD.</b>																		
125 2-STROKE	RE (Ex W.D.) .. ..	1940-45	223/001C	223/001	$\frac{11}{16}$ "	1" dia.	Clip	Fitting		—	—	85	5	3	·107	Combined with	Mix. Chr.	453
250 S.V.	D/SV (Ex W.D.) .. ..	1940-45	274E/4A	274/012R	$\frac{33}{32}$ "	1" dia.	Clip	Fitting		204/058R	21	75	4/5	3	Std.	4A	62/028	440
350 S.V.	C (Ex W.D.) .. .. .	1940-45	274A/4A	274/022R	$\frac{33}{32}$ "	1" dia.	Clip	Fitting		204/059R	25	85	4/5	3	Std.	4A	62/028	440
350 O.H.V.	CO (Ex W.D.) .. .. .	1940-45	276AC/1A	276/405R	$\frac{11}{16}$ "	2 $\frac{1}{2}$ "	2"	$\frac{11}{16}$ "	1"	206/057R	39	130	6/4	2	Std.	1A	64/156	440
125 2-STROKE	RE .. .. .	1946-54	223/001C	223/001	$\frac{11}{16}$ "	1" dia.	Clip	Fitting		—	—	85	5	3	·107	Combined with	Mix. Chr.	453
125 2-STROKE	RE .. .. .	1948	223/3	223/018	$\frac{11}{16}$ "	1·572"				—	—	90	5	3	·107	Combined with	Mix. Chr.	453
148 C.C. 2-STROKE	" Ensign " .. .. .	1953-54	223/6	223/023	$\frac{3}{4}$ "	1·812"	1·572"			—	—	110	5/D	3	·107	Combined with	Mix. Chr.	453
250 O.H.V.	5 .. .. .	1950	274BH/3A	274/022R	$\frac{33}{32}$ "	1" dia.	Clip	Fitting		204/059R	25	75	4/4	2	Std.	3A	62/025	440
250 O.H.V.	S .. .. .	1953	274BS/3A	274/416R	$\frac{33}{32}$ "	1 $\frac{1}{2}$ "	2"	$\frac{11}{16}$ "	$\frac{11}{16}$ "	204/059R	25	75	4/4	2	Std.	3A	62/025	440
250 O.H.V.	" S " .. .. .	1954	274BX/3A	274/416R	$\frac{33}{32}$ "	1 $\frac{1}{2}$ "	2"	$\frac{11}{16}$ "	$\frac{11}{16}$ "	204/059R	25	75	4/4	2	Std.	3A	62/025	440
250 O.H.V.	Clipper .. .. .	1954	274BS/3A	274/416R	$\frac{33}{32}$ "	1 $\frac{1}{2}$ "	2"	$\frac{11}{16}$ "	$\frac{11}{16}$ "	204/059R	25	75	4/4	2	Std.	3A	62/025	440
346 O.H.V.	G .. .. .	1946-54	276BL/1A	276/405R	$\frac{11}{16}$ "	2 $\frac{1}{2}$ "	2"	$\frac{11}{16}$ "	1"	206/057R	39	130	6/4	3	Std.	1A	64/156	440
346 O.H.V.	CO .. .. .	1946-50	276AC/1A	276/405R	$\frac{11}{16}$ "	2 $\frac{1}{2}$ "	2"	$\frac{11}{16}$ "	1"	206/057R	39	130	6/4	3	Std.	1A	64/156	440
346 O.H.V.	G2 " Bullet " .. .. .	1947-54	276CX/1A	276/419R	1"	2 $\frac{1}{2}$ "	2"	$\frac{11}{16}$ "	1"	206/058R	45	140	6/4	3	Std.	1A	64/156	440
346 O.H.V.	G2 " Bullet " .. .. .	1952-54	T10TT9	175/041	1 $\frac{1}{16}$ "	2 $\frac{1}{2}$ "	2"	$\frac{11}{16}$ "	1 $\frac{1}{16}$ "	175/108D	1 $\frac{1}{16}$ "	300	6	4	·109	302/10	302/001	449
346 S.V.	C .. .. .	1947-50	274B/1A	274/022R	$\frac{33}{32}$ "	1" dia.	Clip	Fitting		204/059R	25	85	4/5	3	Std.	1A	64/156	440
499 O.H.V.	J .. .. .	1946-50	276BM/1A	276/001R	$\frac{11}{16}$ "	1 $\frac{1}{2}$ " dia.	Clip	Fitting		206/057R	39	140	6/4	3	Std.	1A	64/156	440
499 O.H.V.	J .. .. .	1948	276CB/1A	276/011R	1"	1 $\frac{1}{2}$ " dia.	Clip	Fitting		206/058R	45	150	6/4	3	Std.	1A	64/156	440
499 O.H.V.	J2 .. .. .	1947-54	276DB/1A	276/130R	1 $\frac{1}{16}$ "	2 $\frac{1}{2}$ "	2"	$\frac{11}{16}$ "	1 $\frac{1}{16}$ "	206/059R	51	170	6/4	2	Std.	1A	64/156	440
496 O.H.V.	Twin .. .. .	1947-48	276DJ/1AT	276/422R	$\frac{11}{16}$ "	1 $\frac{1}{2}$ "	2"	$\frac{11}{16}$ "	1"	206/057R	39	140	6/3	2	·109	1AT (7°)	64/192	440
496 O.H.V.	Twin .. .. .	1949-54	276DU/1AT	276/422R	$\frac{11}{16}$ "	1 $\frac{1}{2}$ "	2"	$\frac{11}{16}$ "	1"	206/057R	39	150	6/4	2	·109	1AT (7°)	64/192	440
500 O.H.V.	J.S. " Bullet " .. .. .	1953-54	289T/1A	289/406R	1 $\frac{1}{8}$ "	2 $\frac{1}{2}$ "	2"	$\frac{11}{16}$ "	1 $\frac{1}{8}$ "	229/069R	58	180	29/3	2	Std.	1A	64/156	440
700 O.H.V.	Twin " Meteor " .. .. .	1952-54	276FJ/1AT	276/436R	1 $\frac{1}{16}$ "	2 $\frac{1}{2}$ "	2"	$\frac{11}{16}$ "	1 $\frac{1}{16}$ "	206/059R	51	170	6/4	3	Std.	1AT (7°)	64/192	440
<b>SAROLEA.</b>																		
125 2-STROKE	.. .. .	1946-54	361/001D	361/001D	$\frac{3}{8}$ "	1" dia.	Clip	Fitting		—	—	90	3	2	·107	Combined with	Mix. Chr.	465
200 C.C. 2-STROKE	.. .. .	1953-54	275BQ/2EC	275/014R	$\frac{7}{8}$ "	1 $\frac{1}{2}$ "	2"	$\frac{11}{16}$ "	$\frac{7}{8}$ "	205/058R	33	100	5/4	4	Std.	2EC	64/187	440
350 S.V.	.. .. .	1945-47	274M/2DQ	274/022R	$\frac{33}{32}$ "	1" dia.	Clip	Fitting		204/059R	25	100	4/5	2	Std.	2DQ	64/163	440
350 S.V.	.. .. .	1948	274AT/2DQ	274/143R	$\frac{33}{32}$ "	1 $\frac{1}{2}$ "	2"	$\frac{11}{16}$ "	$\frac{33}{32}$ "	204/059R	25	100	4/5	2	Std.	2DQ	64/163	440
350-400 S.V.	.. .. .	1949-54	275AT/2DQ	275/161R	$\frac{11}{16}$ "	1 $\frac{1}{2}$ "	2"	$\frac{11}{16}$ "	$\frac{11}{16}$ "	205/057R	28	120	5/4	3	Std.	2DQ	64/163	440
350 O.H.V.	.. .. .	1946-48	206C/1DR	206/140R	$\frac{11}{16}$ "	1 $\frac{11}{16}$ "	2"	$\frac{11}{16}$ "	1"	206/057R	39	140	6/4	3	Std.	1DR (HZ)	64/177B	440
350 O.H.V.	.. .. .	1949-54	206F/1DR	206/150R	1"	1 $\frac{11}{16}$ "	2"	$\frac{11}{16}$ "	1"	206/058R	45	150	6/3	3	Std.	1DR (HZ)	64/177B	440
400 S.V.	Army .. .. .	1951-2	275BM/2DQ	275/161R	$\frac{11}{16}$ "	1 $\frac{1}{2}$ "	2"	$\frac{11}{16}$ "	$\frac{11}{16}$ "	205/057R	28	120	5/4	3	Std.	2DQ	64/163	440
500 O.H.V.	Motocross .. .. .	1951-53	T10TT9	—	1 $\frac{3}{32}$ "	—	2"	$\frac{11}{16}$ "	1 $\frac{3}{32}$ "	—	—	380	9	4	·109	14/535 (15°)	14/225R	449
500 O.H.V.	Motocross .. .. .	1954	T10GP	316/403	1 $\frac{3}{32}$ "	1 $\frac{1}{2}$ "	2"	$\frac{11}{16}$ "	1 $\frac{3}{32}$ "	316/190	1 $\frac{3}{32}$ "	210	3	4	·109	302/10 (15°)	302/001 (15°)	470
500 C.C.	New Twin .. .. .	1952-54	276FN/1DZ	276/132R	$\frac{11}{16}$ "	1 $\frac{1}{2}$ "	2"	$\frac{11}{16}$ "	$\frac{11}{16}$ "	206/057R (LH)	39	150	6/3	4	·107	1DZ (15°)	64/354B	440
600 S.V.	.. .. .	1948-53	276DG/1DR	276/001R	$\frac{11}{16}$ "	1 $\frac{1}{2}$ " dia.	Clip	Fitting		206/057R	39	150	6/4	3	Std.	1DR (HZ)	64/177B	440
600 O.H.V.	.. .. .	1946-53	289J/1DR	289/116R	1 $\frac{1}{2}$ "	2"	2"	$\frac{11}{16}$ "	1 $\frac{1}{2}$ "	229/069R	58	180	29/4	3	Std.	1DR (HZ)	64/177B	440
600 C.C. TWIN	.. .. .	1953-54	276FX/1DZ	276/117R	1"	2"	2"	$\frac{11}{16}$ "	1"	206/058R (LH)	45	170	6/4	4	·107	1DZ	64/354B	440
<b>SCOTT.</b>																		
98 2-STROKE	Mark II .. .. .	1946-52	265/2	265/002	·475"	$\frac{3}{4}$ " dia.	Clip	Fitting		—	—	60	3	3	·107	Combined with	Mix. Chr.	422R
596 2-STROKE	Flying Squirrel .. .. .	1946-52	206/151R	206/151R	1 $\frac{1}{16}$ "	Special Flange				206/059R	51	170	6/3	3	Std.	14/092	14/111	440



1940 to 1954 (inclusive) SETTINGS AND SPARE PARTS LIST—continued

LIST No. 601/2  
(ISSUE NO. 2)

Machine and Engine Details			ENGINE END DETAILS							JET BLOCK		Jet Size	Throttle Valve	Needle Position	Needle Jet	Float Chbr. Type No.	Float Chbr. Body Part No.	Spare Parts List No.	
			Capacity	Model	Year	Carburetter Type No.	Mix. Chbr. Body No.	Internal Bore	Centre Line of Body to Face of Fl'ge	Flange Centres	Dia. of Bolt Holes								Dia. at Engine End
<b>SUNBEAM.</b>																			
487 O.H.V.	S7	.. .. .	1946-52	276BO/3A	276/132R	1 1/8"	1 1/2"	2"	1 1/2"	1 1/8"	206/057R(LH)	39	150	6/3	3	-107	3A	62/025	440
487 O.H.V.	S7, Export	.. .. .	1947-52	276CQ/3A	276/132R	1 1/8"	1 1/2"	2"	1 1/2"	1 1/8"	206/057R(LH)	39	150	6/3	3	-107	3A	62/025	440
487 O.H.V.	S8	.. .. .	1949-54	276DO/3A	276/424R	1 1/8"	1 1/2"	2"	1 1/2"	1 1/8"	206/057R(LH)	39	150	6/3	2	-107	3A	62/025	440
<b>TRIUMPH.</b>																			
350 O.H.V.	(Ex W.D.)	.. .. .	1940-45	276AD/1J	276/014R	1"	1 1/2"	2"	1 1/2"	1"	206/058R	45	150	6/4	2	-107	1J (15°)	64/186	440
149 C.C.	Terrier	... .. .	1953	332/1	332/001	3/4"	1 1/2"	1-574"	-257	3/4"	—	—	120	4	2	-086	3EB	62/214	484
149 C.C.	Terrier	.. .. .	1954	332/2	332/023	1 1/8"	1 1/2"	1-574"	-257	1 1/8"	—	—	20P 90M	4	3	-086	3EB	62/214	484
199 C.C.	T2 Tiger Cub	.. .. .	1954	332/3	332/025	3/4"	1 1/2"	—	-257	3/4"	—	—	20P100M	4	3	-086	3EB	62/214	484
349 O.H.V.	3T De-Luxe	.. .. .	1946-48	275AD/1A	275/145R	7/8"	2 1/2"	2"	1 1/2"	7/8"	205/058R	33	120	5/4	3	-107	1A	64/156	440
349 O.H.V.	3T De-Luxe	.. .. .	1949-50	275AQ/1A	275/145R	7/8"	2 1/2"	2"	1 1/2"	7/8"	205/058R	33	120	5/4	3	-107	1A	64/156	440
349 O.H.V.	3T De-Luxe	.. .. .	1951-52	275BK/1A	275/412R	7/8"	2 1/2"	2"	1 1/2"	7/8"	205/058R	33	120	5/4	3	-107	1A	64/156	440
349 O.H.V.	Tiger "85"	.. .. .	1946-49	275AD/1A	275/145R	7/8"	2 1/2"	2"	1 1/2"	7/8"	205/058R	33	120	5/4	3	-107	1A	64/156	440
498 O.H.V.	Tiger "100"	.. .. .	1946-48	276BN/1AT	276/411R	1"	1 1/2"	2"	1 1/2"	1 1/8"	206/058R	45	160	6/3 1/2	3	-107	1AT (7°)	64/192	440
498 O.H.V.	Tiger "100"	.. .. .	1949-50	276DL/1AT	276/411R	1"	1 1/2"	2"	1 1/2"	1 1/8"	206/058R	45	150	6/3 1/2	2	-107	1AT (7°)	64/192	440
498 O.H.V.	Tiger "100"	.. .. .	1951-53	276FH/1AT	276/432R	1"	1 1/2"	2"	1 1/2"	1 1/8"	206/058R	45	150	6/3 1/2	2	-107	1AT (7°)	64/192	440
498 C.C.	Tiger 100	.. .. .	1954	276GE/2EK	276/432R	1"	1 1/2"	2"	1 1/2"	1 1/8"	206/058R	45	150	6/3 1/2	2	-107	2EK	64/163	440
498 O.H.V.	5T	.. .. .	1946-48	276AX/1AT	276/410R	1 1/8"	1 1/2"	2"	1 1/2"	1 3/32"	206/057R	39	140	6/3 1/2	3	-107	1AT (7°)	64/192	440
498 O.H.V.	5T	.. .. .	1949-50	276DK/1AT	276/410R	1 1/8"	1 1/2"	2"	1 1/2"	1 3/32"	206/057R	39	140	6/3 1/2	3	-107	1AT (7°)	64/192	440
498 O.H.V.	5T	.. .. .	1951-53	276FE/1AT	276/433R	1 1/8"	1 1/2"	2"	1 1/2"	1 3/32"	206/057R	39	140	6/3 1/2	3	-107	1AT (7°)	64/192	440
498 O.H.V.	T100 Racing	.. .. .	1949-50	(LH) 76AJ	76/117	1"	1 1/2"	2"	1 1/2"	1" (LH)	6/058	45	130	6/4	3	-109	14/538	14/217R	440, 441
				(RH) 76AH	76/014	1"	1 1/2"	2"	1 1/2"	1"	6/058	45	130	6/4	3	-109			
498 O.H.V.	T 100 Racing	.. .. .	1951-52	(LH) 76AO	76/415	1"	1 1/2"	2"	1 1/2"	1" (LH)	6/058	45	190	6/4	3	-109	14/538	14/217R	440, 441
				(RH) 76AN	76/414	1"	1 1/2"	2"	1 1/2"	1"	6/058	45	190	6/4	3	-109			
498 O.H.V.	TR5 Trophy	.. .. .	1950	276EK/1A	276/426R	1 1/8"	1 1/2"	2"	1 1/2"	1 3/32"	206/057R	39	140	6/3 1/2	3	-107	1A	64/156	440
498 O.H.V.	TR5 Trophy	.. .. .	1951-53	276FF/1AT	276/432R	1"	1 1/2"	2"	1 1/2"	1 1/8"	206/058R	45	150	6/3 1/2	2	-107	1AT (7°)	64/192	440
498 C.C.	TR5	.. .. .	1954	276GH	276/432R	1"	1 1/2"	2"	1 1/2"	1 1/8"	206/058R	45	150	6/3 1/2	2	-107	302/13	302/048	440, 449
649	Tiger 110	.. .. .	1954	289X	289/407R	1 1/8"	1 1/2"	2"	1 1/2"	1 1/8"	229/069R	58	200	29/4	3	-107	302/13	302/048	440, 449
650 O.H.V.	Thunderbird, 6T	.. .. .	1950	276EA/1AT	276/411R	1"	1 1/2"	2"	1 1/2"	1 1/8"	206/058R	45	170	6/3 1/2	2	-107	1AT (7°)	64/192	440
650 O.H.V.	Thunderbird, 6T	.. .. .	1950	276EW/1AT	276/429R	1 1/8"	1 1/2"	2"	1 1/2"	1 1/8"	206/059R	51	140	6/3 1/2	2	-107	1AT (7°)	64/192	440
650 O.H.V.	Thunderbird, 6T	.. .. .	1951-53	276FG/1AT	276/434R	1 1/8"	1 1/2"	2"	1 1/2"	1 1/8"	206/059R	51	140	6/3 1/2	2	-107	1AT (7°)	64/192	440
	T100C	... .. .	1953	R.H. 76AR	76/414	1"	1 1/2"	2"	1 1/2"	1"	6/058R	45	150	6/4	2	-107	14/538	14/217R	440, 441
				L.H. 76AS	76/415	1"	1 1/2"	2"	1 1/2"	1"	6/058R(LH)	45	150	6/4	2	-107			
	3T, for A.A.	... .. .	1953	274AB/1AT	274/405R	3/4"	1 1/2"	2"	1 1/2"	3/4"	204/057R	17	75	4/4	1	Std.	1AT (7°)	64/192	440



Machine and Engine Details			Carburettor Type No.	Mix. Chbr. Body No.	Internal Bore	ENGINE END DETAILS				JET BLOCK		Jet Size	Throttle Valve	Needle Position	Needle Jet	Float Chbr. Type No.	Float Chbr. Body Part No.	Spare Parts List No.
						Centre Line of Body to Face of Fl'ge	Flange Centres	Dia. of Bolt Holes	Dia. at Engine End	Part No.	Size No.							
Capacity	Model	Year																
<b>VELOCETTE.</b>																		
349 O.H.V.	M.A.C. (Ex W.D.)	.. 1940-45	76Y/1J	76/406	1"	1 1/8" dia.	Clip	Fitting		6/058	45	170	6/4	2	Std.	1J (15°)	64/186	440
349 O.H.V.	M.A.F. (Ex W.D.)	.. 1940-45	276AF/1J	276/004VR	1 1/8"	1 1/2"	2"	1 1/2"	1 1/8"	206/057R	39	120	6/4	2	Std.	1J (15°)	64/186	440
248 O.H.V.	M.O.V.	.. .. 1946-49	275AB/1J	275/406R	7/8"	1 1/2"	2"	1 1/2"	7/8"	205/058R	33	120	5/3	3	Std.	1J (15°)	64/186	440
349 O.H.V.	M.A.C.	.. .. 1946-50	276BT/1J	276/415R	1 1/8"	1 1/2"	2"	1 1/2"	1 1/8"	206/057R	39	130	6/3	3	Std.	1J (15°)	64/186	440
349 O.H.V.	M.A.C.	.. .. 1951-54	276EY/1AT	276/415R	1 1/8"	1 1/2"	2"	1 1/2"	1 1/8"	206/057R	39	130	6/3	3	-107	1AT (7°)	64/192	440
348 O.H.C.	KSS	.. .. 1946-47	276BU/1J	276/414R	1"	1 1/2"	2"	1 1/2"	1"	206/058R	45	150	6/3	3	Std.	1J (15°)	64/186	440
348 O.H.C.	KSS	.. .. 1948-49	276CV/1J	276/418R	1 1/8"	1 1/2"	2"	1 1/2"	1 1/8"	206/059R	51	160	6/3	3	Std.	1J (15°)	64/186	440
348 O.H.C.	KTT	.. .. 1946-50	T10TT	175/271RR	1 3/32"	1 3/4"	2"	1 3/2"	1 3/32"	175/272D	—	400	4	2	-109	14/538	14/217R	441R
495 O.H.V.	MSS	.. .. 1946-49	276BS/1AT	276/416R	1 1/8"	1 1/2"	2"	1 1/2"	1 1/8"	206/059R	51	180	6/4	3	Std.	1AT (7°)	64/192	440
149 TWIN	LE and LE 200	.. 1949-54																
This Carburettor is serviced and Spare Parts supplied only by Velocette Limited.																		
<b>VINCENT</b>																		
47 C.C.	Firefly	.. .. 1954	308/23	308/100	-39°	1 1/2" dia.	Clip	Fitting		—	—	30	2	3	-0745	Bottom Feed	308/013	463
47 C.C.	Firefly	.. .. 1954	335/3	335/045	-39°	3/8" dia.	Clip	Fitting		—	—	30	2	3	-0745	Combined with	Mix. Chr.	491
98 C.C. 2-STROKE		.. .. 1954	361/14	361/032D	-531°	1" dia.	Clip	Fitting		—	—	65	3	2	-107	Combined with	Mix. Chr.	465
98 C.C. 4-STROKE		.. .. 1954	361/16	361/032D	-531°	1" dia.	Clip	Fitting		—	—	65	3	3	-107	Combined with	Mix. Chr.	465
123 C.C. 2-STROKE		.. .. 1954	361/13	361/001D	3/8"	1" dia.	Clip	Fitting		—	—	75	3	2	-107	Combined with	Mix. Chr.	465
123 C.C. 4-STROKE		.. .. 1954	361/15	361/001D	3/8"	1" dia.	Clip	Fitting		—	—	75	3	2	-107	Combined with	Mix. Chr.	465
499 O.H.V.	Comet	.. .. 1949-54	229F/1DV	229/112R	1 1/8"	1 1/4" dia.	Clip	Fitting		229/069R	58	200	29/3	3	Std.	1DV	64/154B	440
499 O.H.V.	Meteor	.. .. 1954	276DQ/1DV	276/125R	1 1/8"	1 1/4" dia.	Clip	Fitting		206/059R(LH)	51	170	6/4	3	Std.	1DV	64/154B	440
499 O.H.V.	Grey Flash (Alcohol Setting)	.. .. 1950-52	T10TT9	175/059	32 mm.	1 1/4" dia.	Clip	Fitting		—	—	1700	7	4	-120	14/533	14/225R	449
998 O.H.V.	" B " Rapide	.. .. 1946-49	Front Carb. 276CJ/1DO	276/125R	1 1/8"	1 1/4" dia.	Clip	Fitting		206/059R(LH)	51	170	6/4	3	Std.	1DO	64/156B	440
			Rear Carb. 276CH/2DS	276/022R	1 1/8"	1 1/4" dia.	Clip	Fitting		206/059R	51	170	6/4	3	Std.	2DS	64/161	440
998 O.H.V.	" C " Rapide	.. .. 1949-54	Front Carb. 276DQ/1DV	276/125R	1 1/8"	1 1/4" dia.	Clip	Fitting		206/059R(LH)	51	170	6/4	3	Std.	1DV	64/154B	440
			Rear Carb. 276CH/2DS	276/022R	1 1/8"	1 1/4" dia.	Clip	Fitting		206/059R	51	170	6/4	3	Std.	2DS	64/161	440
998 O.H.V.	Black Shadow	.. .. 1947-48	Front Carb. 289M/1DO	229/112R	1 1/8"	1 1/4" dia.	Clip	Fitting		229/069R(LH)	58	200	29/4	3	Std.	1DO	64/156B	440
			Rear Carb. 289N/2DS	289/011R	1 1/8"	1 1/4" dia.	Clip	Fitting		229/069R	58	180	29/4	3	Std.	2DS	64/161	440
998 O.H.V.	Black Shadow	.. .. 1949-54	Front Carb. 229E/1DV	229/112R	1 1/8"	1 1/4" dia.	Clip	Fitting		229/069R(LH)	58	180	29/4	3	* Std.	1DV	64/154B	440
			Rear Carb. 289N/2DS	289/011R	1 1/8"	1 1/4" dia.	Clip	Fitting		229/069R	58	180	29/4	3	Std.	2DS	64/161	440
998 O.H.V.	Black Lightning	.. .. 1949-53	T10TT9	175/047	1 3/16"	1 3/4"	2"	1 1/2"	1 3/16"	175/101D	—	360	7	4	-109	14/533	14/225R	449
			T10TT9	175/047	1 3/16"	1 3/4"	2"	1 1/2"	1 3/16"	175/101D	—	360	7	4	-109	14/534 (15°)	14/225R(15°)	449
998 O.H.V.	Black Lightning	.. 1954	T10TT9	175/059	32 mm.	1 1/4" dia.	Clip	Fitting		—	—	1700	7	4	-120	14/533	14/225R	449

MIXING CHAMBER SPARE PARTS

LIST No. 601/2 (ISSUE NO. 2)

COMPONENT	204 C	274 A, B	274 D, J AU BT BU	274 E	274 K, L, AG, AS, BB, BC, BH, BJ, BM, BN, BS	274 M AN, AO	274 AB	274 AJ AK	274 AR	274 AT	274 BE	274 BF	274 BP	274 BR	274 BX
Mixing Chamber Body .. .. .						Refer to	Settings	List for	Part Numbers						
Jet Block, complete .. .. .						Refer to	Settings	List for	Part Numbers						
Mixing Chamber Top .. .. .	4/032	4/032	4/032	4/032	4/032	—	4/205	4/032	4/032	—	—	4/032	4/032	4/032	4/032
Mixing Chamber Cap Ring .. .. .	4/031	4/031	4/031	4/031	4/031	4/031	4/031	4/031	4/031	4/031	4/031	4/031	4/031	4/031	4/031
Fixing Spring for Cap .. .. .	4/235	4/235	4/235	4/235	4/235	4/235	4/235	4/235	4/235	4/235	4/235	4/235	4/235	4/235	4/235
Screw for Fixing Spring for Cap .. .. .	4/241	4/241	4/241	4/241	4/241	4/241	4/241	4/241	4/241	4/241	4/241	4/241	4/241	4/241	4/241
Cable Adjuster .. .. .	4/035	4/035	4/035	4/035	4/035	4/035	—	4/035	4/035	4/035	4/035	4/035	4/035	4/035	4/035
Cable Top Hat Ferrules .. .. .	—	—	—	—	—	—	6/132	—	—	—	—	—	—	—	—
Cable Tube .. .. .	—	—	—	—	—	—	—	—	—	—	—	—	—	—	—
Cable Tube Locknut .. .. .	—	—	—	—	—	—	—	—	—	—	—	—	—	—	—
Throttle Valve .. .. .	4/052	4/052	4/052	4/052	4/052	4/052	4/052	4/052	4/052	4/052	4/052	4/052	4/052	4/052	4/052
Throttle Valve Spring .. .. .	4/263	4/263	4/263	4/263	4/263	4/263	4/263	4/290	4/263	4/263	4/263	4/263	4/263	4/263	4/263
Throttle Valve Cotter Pin .. .. .	4/060	4/060	4/060	4/060	4/060	4/060	4/060	4/060	4/060	4/060	4/060	4/060	4/060	4/060	4/060
Taper Needle .. .. .	4/065	4/065	4/065	4/065	4/065	4/065	4/065	4/065	4/065	4/065	4/065	4/065	4/065	4/065	4/065
Needle Clip .. .. .	4/230	4/230	4/230	4/230	4/230	4/230	4/230	4/230	4/230	4/230	4/230	4/230	4/230	4/230	4/230
Air Valve .. .. .	4/045	4/045	—	4/045	4/045	—	4/045	—	4/045	—	—	4/045	—	—	4/045
Air Valve Guide .. .. .	4/047	4/047	—	4/047	4/047	—	4/047	—	4/047	—	—	4/047	—	—	4/047
Air Valve Spring .. .. .	4/046	4/046	—	4/046	4/046	—	4/046	—	4/046	—	—	4/046	—	—	4/046
Air Valve Ass., com. with M/c. Top, etc.	—	—	—	—	—	4/282	—	4/282	—	4/282	4/282	—	—	—	—
Needle Jet .. .. .	4/061	4/061	4/061	4/061	4/061	4/061	4/061	4/061	4/061	4/061	4/061	4/061	4/061	4/061	4/061
Main Jet .. .. .	4/042	4/042	4/042	4/042	4/042	4/042	4/042	4/042	4/042	4/042	4/042	4/042	4/042	4/042	4/042
Mixing Chamber Union Nut .. .. .	4/062	4/062	4/062	4/062	4/062	4/062	4/062	4/062	4/062	4/062	4/062	4/062	4/062	4/062	4/062
Washer for Mixing Chamber Union Nut	4/040	4/040	4/040	4/040	4/040	4/040	4/040	4/040	4/040	4/040	4/040	4/040	4/040	4/040	4/040
Holding Bolt for Float Chamber .. .. .	4/043	4/043	4/043	4/043	4/043	4/043	4/043	4/043	4/043	4/043	4/043	4/043	4/043	4/043	4/043
Washer for Holding Bolt for Fl. Chamber	4/053	4/053	4/053	4/053	4/053	4/053	4/053	4/053	4/053	4/053	4/053	4/053	4/053	4/053	4/053
Pilot Air Adjusting Screw .. .. .	13/129	13/129	13/129	13/129	13/129	13/129	13/129	13/129	13/129	13/129	13/129	13/129	13/129	13/129	13/129
Pilot Air Adjusting Spring .. .. .	4/148	4/148	4/148	4/148	4/148	4/148	4/148	—	4/148	4/148	4/148	4/148	4/148	4/148	4/148
Pilot Air Adjusting Locknut .. .. .	—	—	—	—	—	—	—	16/010	—	—	—	—	—	—	—
Throttle Stop Screw .. .. .	4/063	4/063	4/063	4/063	4/063	4/063	4/063	4/063	4/063	4/063	4/063	4/063	4/063	4/063	4/063
Throttle Stop Screw Locknut .. .. .	16/010	16/010	16/010	16/010	16/010	16/010	16/010	16/010	16/010	16/010	16/010	16/010	16/010	16/010	16/010
Outlet Clip .. .. .	—	4/207	—	4/207	—	4/207	—	—	4/207	—	—	—	4/207	—	—
Outlet Clip Screw .. .. .	—	4/048	—	4/048	—	4/048	—	—	4/048	—	—	—	4/048	—	—
Air Intake Tube .. .. .	4/038	—	4/038	4/038	4/038	4/038	4/038	6/038	—	4/038	—	—	—	—	—
Air Tube (Domed) .. .. .	—	—	—	—	—	—	—	—	30/310	—	—	—	—	—	—
Gauze Intake, complete .. .. .	—	—	—	—	—	—	—	—	—	—	—	—	325/1	244/790	—
Gauze Intake, complete .. .. .	—	30/330C	—	—	—	—	—	—	—	—	—	—	—	—	30/330C
Gauze Intake, Body only .. .. .	—	30/109	—	—	—	—	—	—	—	—	—	—	—	—	30/109
Gauze Intake, Gauze .. .. .	—	30/110	—	—	—	—	—	—	—	—	—	—	—	—	30/110
Gauze Intake Clip .. .. .	—	30/080	—	—	—	—	—	—	—	—	—	—	—	—	30/080
Gauze Intake, Adaptor .. .. .	—	30/129	—	—	—	—	—	—	—	—	—	—	—	34/009	30/129
Strangler Intake Cowl .. .. .	—	—	—	—	—	—	—	—	—	—	—	—	—	—	—
Strangler Intake Cowl Nut .. .. .	—	—	—	—	—	—	—	—	—	—	—	—	—	—	—
Strangler Intake Fixing Clip .. .. .	—	—	—	—	—	—	—	—	—	—	—	—	—	—	—
Strangler Intake Fixing Clip Pin .. .. .	—	—	—	—	—	—	—	—	—	—	—	—	—	—	—
Strangler Intake Fixing Pin Nut .. .. .	—	—	—	—	—	—	—	—	—	—	—	—	—	—	—
Strangler Intake Adaptor .. .. .	—	—	—	—	—	—	—	—	—	—	—	—	—	—	—
Air Intake Screwed Ring .. .. .	—	—	—	—	—	—	—	—	—	—	—	—	—	—	—
Air Filter .. .. .	—	—	—	—	—	—	—	—	—	—	—	—	—	—	—
Plug Screw for Mixing Chamber Top .. .. .	—	—	4/137A	—	—	4/137A	—	—	—	4/137A	4/137A	—	4/137A	4/137A	—



COMPONENT	75 B	275 F	205G, 275 A, B, S, P AC, AN AQ, AU BC, BD BE, BK	275 AB	275 AD	275 AE	275 AK	275 AR, AS BA, BB	275 AT	275 BL, BM	275 BO	275 BP	275 BQ	275 BS BU		
Mixing Chamber Body .. .. .																
Jet Block, complete .. .. .																
Mixing Chamber Top .. .. .	4/032	4/032	4/032	4/032	—	4/032	4/032	4/032	—	—	4/032	4/032	4/032	4/032		
Mixing Chamber Cap Ring .. .. .	4/031	4/031	4/031	4/031	4/031	4/031	4/031	4/031	4/031	4/031	4/031	4/031	4/031	4/031	4/031	
Fixing Spring for Cap .. .. .	4/235	4/235	4/235	4/235	4/235	4/235	4/235	4/235	4/235	4/235	4/235	4/235	4/235	4/235	4/235	
Screw for Fixing Spring for Cap .. .. .	4/241	4/241	4/241	4/241	4/241	4/241	4/241	4/241	4/241	4/241	4/241	4/241	4/241	4/241	4/241	
Cable Adjuster .. .. .	4/035	4/035	4/035	4/035	4/035	4/035	4/035	4/035	4/035	4/035	4/035	4/035	4/035	4/035	4/035	
Cable Top Hat Ferrules .. .. .	—	—	—	—	—	—	—	—	—	—	—	—	—	—	—	
Cable Tube .. .. .	—	—	—	—	—	—	—	—	—	—	—	—	—	—	—	
Cable Tube Locknut .. .. .	—	—	—	—	—	—	—	—	—	—	—	—	—	—	—	
Throttle Valve .. .. .	5/052	5/052	5/052	5/052	5/052	5/052	5/052	5/052	5/052	5/052	5/052	5/052	5/052	5/052	5/052	
Throttle Valve Spring .. .. .	4/263	4/037	4/263	4/263	—	4/263	4/263	4/263	4/263	4/263	4/263	4/263	4/263	4/263	4/263	
Throttle Valve Cotter Pin .. .. .	4/060	4/060	4/060	4/060	—	4/060	4/060	4/060	4/060	4/060	4/060	4/060	4/060	4/060	4/060	
Taper Needle .. .. .	5/065	5/065	5/065	5/065	5/065	5/065	5/065	5/065	5/065	5/065	5/065	5/065	5/065	5/065	5/065	
Needle Clip .. .. .	4/230	4/230	4/230	4/230	4/230	4/230	4/230	4/230	4/230	4/230	4/230	4/230	4/230	4/230	4/230	
Air Valve .. .. .	5/045	5/045	5/045	5/045	—	—	5/045	5/045	—	—	5/045	—	—	—	—	
Air Valve Guide .. .. .	5/047	5/047	5/047	5/047	—	—	5/047	5/047	—	—	5/047	—	—	—	—	
Air Valve Spring .. .. .	4/046	4/046	4/046	4/046	—	—	4/046	4/046	—	—	4/046	—	—	—	—	
Air Valve Assembly complete M/c. Top and Con. Rod	—	—	—	—	30/306	—	—	—	5/503	5/503	—	—	—	—	—	
Needle Jet .. .. .	4/061	4/061	4/061	4/061	4/061	4/061	4/061	4/061	4/061	4/061	4/061	4/061	4/061	4/061	4/061	
Main Jet .. .. .	4/042	4/042	4/042	4/042	4/042	4/042	4/042	4/042	4/042	4/042	4/042	4/042	4/042	4/042	4/042	
Mixing Chamber Union Nut .. .. .	4/062	4/062	4/062	4/062	4/062	4/062	4/062	4/062	4/062	4/062	4/062	4/062	4/062	4/062	4/062	
Washer for Mixing Chamber Union Nut .. .. .	4/040	4/040	4/040	4/040	4/040	4/040	4/040	4/040	4/040	4/040	4/040	4/040	4/040	4/040	4/040	
Holding Bolt for Float Chamber .. .. .	4/043	4/043	4/043	4/043	4/043	4/043	4/043	4/043	4/043	4/043	4/043	4/043	4/043	4/043	4/043	
Washer for Holding Bolt for Float Chamber .. .. .	4/053	4/053	4/053	4/053	4/053	4/053	4/053	4/053	4/053	4/053	4/053	4/053	4/053	4/053	4/053	
Pilot Air Adjusting Screw .. .. .	13/129	13/129	13/129	13/129	13/129	13/129	13/129	13/129	13/129	13/129	13/129	13/129	13/129	13/129	13/129	
Pilot Air Adjusting Spring .. .. .	4/148	—	4/148	4/148	4/148	4/148	4/148	4/148	4/148	4/148	4/148	4/148	4/148	4/148	4/148	
Pilot Air Adjusting Locknut .. .. .	—	4/206	—	—	—	—	—	—	—	—	—	—	—	—	—	
Throttle Stop Screw .. .. .	4/063	4/063	4/063	—	4/063	4/063	4/063	4/063	4/063	4/063	4/063	4/063	4/063	4/063	4/063	
Throttle Stop Screw Locknut .. .. .	16/010	4/206	16/010	—	16/010	16/010	16/010	16/010	16/010	16/010	16/010	16/010	16/010	16/010	16/010	
Throttle Stop Screw with Tommy Bar .. .. .	—	—	—	15/2546	—	—	—	—	—	—	—	—	—	—	—	
Body for Throttle Stop Screw with Tommy Bar .. .. .	—	—	—	15/1860	—	—	—	—	—	—	—	—	—	—	—	
Screw for Throttle Stop Screw with Tommy Bar .. .. .	—	—	—	15/1988	—	—	—	—	—	—	—	—	—	—	—	
Spring for Throttle Stop Screw with Tommy Bar .. .. .	—	—	—	15/203	—	—	—	—	—	—	—	—	—	—	—	
Outlet Clip .. .. .	—	—	5/200	—	—	5/200	4/207	—	—	—	—	—	—	—	—	
Outlet Clip Screw .. .. .	—	—	4/048	—	—	4/048	4/048	—	—	—	—	—	—	—	—	
Air Intake Tube .. .. .	4/038	4/038	4/038	4/038	4/038	4/038	—	—	4/038	—	—	—	—	—	—	
Air Tube (Domed) .. .. .	—	—	—	—	—	—	30/310	—	—	—	—	—	—	—	—	
Gauze Intake, complete .. .. .	—	—	—	—	—	—	—	—	—	—	—	244/790	325/2	—	—	
Gauze Intake, complete .. .. .	—	—	—	—	—	—	—	—	—	—	96/101	—	—	—	—	
Gauze Intake, complete .. .. .	—	—	—	—	—	—	—	—	—	30/330C	—	—	—	—	—	
Gauze Intake Body only .. .. .	—	—	—	—	—	—	—	—	—	30/109	—	—	—	—	—	
Gauze Intake Gauze .. .. .	—	—	—	—	—	—	—	—	—	30/110	—	—	—	—	—	
Gauze Intake Clip .. .. .	—	—	—	—	—	—	—	—	—	30/080	—	—	—	—	—	
Gauze Intake Adaptor .. .. .	—	—	—	—	—	—	—	—	—	30/129	96/006	34/009	—	—	—	
Air Intake Tube with Gauze .. .. .	—	—	—	—	—	—	—	204/416	—	—	—	—	—	—	—	
Plug Screw for Mixing Chamber Top .. .. .	—	—	—	—	—	—	—	—	—	—	—	4/137A	4/137A	4/137A	—	

MIXING CHAMBER SPARE PARTS—continued

LIST No. 601/2 (ISSUE NO. 2)

COMPONENT	76 A D P AE	76 C AH, AJ AR, AS	76 Y	76 AG, AL AQ, AP AT	76 AK AN AO	76 AM	76 AV	206 C F 276 EJ	206 G H	276 B	276 C P	276 E, AD, AZ BB, BH BP, BV CG, DZ FK, FL GK, GL	276 L BL BR	276 AC	276 AE
Mixing Chamber Body .. .. .								Refer to S	Settings List	for Part	Numbers				
Jet Block, complete .. .. .								Refer to S	Settings List	for Part	Numbers				
Mixing Chamber Top .. .. .	6/032	6/403	6/032	6/032	6/423	6/423	6/032	—	—	6/032	6/032	6/032	6/032	6/032	6/032
Mixing Chamber Cap Ring .. .. .	6/031	6/031	6/031	6/031	6/031	6/031	6/031	6/031	6/031	6/031	6/031	6/031	6/031	6/031	6/031
Fixing Spring for Cap .. .. .	4/235	4/235	4/235	4/235	4/235	4/276	4/235	4/235	6/248	4/235	4/235	4/235	4/235	6/248	4/235
Screw for Fixing Spring for Cap .. .. .	4/241	4/241	4/241	4/241	4/241	4/241	4/241	4/241	4/241	4/241	4/241	4/241	4/241	4/241	4/241
Cable Adjuster .. .. .	4/035	—	4/035	4/035	4/035	4/035	4/035	4/035	4/035	4/035	4/035	4/035	4/035	4/035	4/035
Cable Top Hat Ferrules .. .. .	—	6/132	—	—	6/132	6/132	—	—	—	—	—	—	—	—	—
Cable Tube .. .. .	—	—	—	—	—	—	—	—	—	—	—	—	—	—	—
Cable Tube Locknut .. .. .	—	—	—	—	—	—	—	—	—	—	—	—	—	—	—
Throttle Valve .. .. .	6/052	6/052	6/213	6/052	6/052	6/052	6/052	6/052	6/052	6/052	6/052	6/052	6/052	6/052	6/052
Throttle Valve Spring .. .. .	29/047	4/263	—	29/047	4/263	4/263	4/263	4/263	4/263	4/263	4/263	4/263	4/263	4/263	4/263
Throttle Valve Cotter Pin .. .. .	4/060	4/060	—	4/060	4/060	4/060	4/060	4/060	4/060	4/060	4/060	4/060	4/060	4/060	4/060
Taper Needle .. .. .	6/065	6/065	6/065	6/065	6/065	6/065	6/065	6/065	6/065	6/065	6/065	6/065	6/065	6/065	6/065
Needle Clip .. .. .	4/230	4/230	4/230	4/230	4/230	4/230	4/230	4/230	4/230	4/230	4/230	4/230	4/230	4/230	4/230
Air Valve .. .. .	6/045	—	6/045	6/045	6/045	6/045	6/045	—	—	6/045	6/045	6/045	6/045	6/045	6/045
Air Valve Guide .. .. .	6/047	—	6/047	6/047	6/047	6/047	6/047	—	—	6/047	6/047	6/047	6/047	6/047	6/047
Air Valve Spring .. .. .	4/046	—	4/046	4/046	4/046	4/046	4/046	—	—	4/046	4/046	4/046	4/046	4/046	4/046
Air Valve Assembly complete, M/c. T. & C. Rod	—	—	—	—	—	—	—	6/417	6/417	—	—	—	—	—	—
Needle Jet .. .. .	4/061	4/061	4/061	4/061	4/061	4/061	4/061	4/061	4/061	4/061	4/061	4/061	4/061	4/061	4/061
Main Jet .. .. .	4/042	4/042	4/042	4/042	4/042	4/042	4/042	4/042	4/042	4/042	4/042	4/042	4/042	4/042	4/042
Mixing Chamber Union Nut .. .. .	6/062	6/062	6/062	6/062	6/062	6/062	6/062	6/062	6/210	6/062	6/033	6/062	6/033	6/033	6/033
Washer for Mixing Chamber Union Nut .. .. .	6/040	6/040	6/040	6/040	6/040	6/040	6/040	6/040	6/040	6/040	6/040	6/040	6/040	6/040	6/040
Holding Bolt for Float Chamber .. .. .	4/043	4/043	4/043	4/043	4/043	4/043	4/043	4/043	4/043	4/043	4/043	4/043	4/043	4/043	4/043
Washer for Holding Bolt for Float Chamber	4/053	4/053	4/053	4/053	4/053	4/053	4/053	4/053	4/053	4/053	4/053	4/053	4/053	4/053	4/053
Pilot Air Adjusting Screw .. .. .	13/129	13/129	13/129	13/129	13/129	13/129	13/129	13/129	13/129	13/129	13/129	13/129	13/129	13/129	13/129
Pilot Air Adjusting Spring .. .. .	—	4/148	4/148	—	4/148	4/148	—	4/148	4/148	—	4/148	4/148	4/148	4/148	—
Pilot Air Adjusting Locknut .. .. .	4/206	—	—	4/206	—	—	4/206	—	—	4/206	—	—	—	—	16/010
Throttle Stop Screw .. .. .	4/063	4/063	—	4/063	4/063	4/063	4/063	4/063	4/063	4/063	4/063	4/063	4/063	4/063	4/063
Throttle Stop Screw Locknut .. .. .	4/206	16/010	—	4/206	16/010	16/010	4/206	16/010	16/010	4/206	16/010	16/010	16/010	16/010	16/010
Throttle Stop Screw with Tommy Bar .. .. .	—	—	15/2546	—	—	—	—	—	—	—	—	—	—	—	—
Body for Throttle Stop Screw with Tommy Bar	—	—	15/1860	—	—	—	—	—	—	—	—	—	—	—	—
Screw for Throttle Stop Screw with Tommy Bar	—	—	15/1988	—	—	—	—	—	—	—	—	—	—	—	—
Spring for Throttle Stop Screw with Tommy Bar	—	—	13/203	—	—	—	—	—	—	—	—	—	—	—	—
Outlet Clip .. .. .	—	—	—	—	—	—	—	—	—	—	—	—	—	—	5/200
Outlet Clip Screw .. .. .	—	—	—	—	—	—	—	—	—	—	—	—	—	—	4/048
Air Intake Tube .. .. .	6/038	6/038	6/038	6/038	6/038	6/038	6/038	6/038	—	6/038	—	6/038	6/038	—	6/038
Gauze Intake, complete .. .. .	—	—	—	—	—	—	—	—	30/109C	—	—	—	—	30/109C	—
Gauze Intake, Body only .. .. .	—	—	—	—	—	—	—	—	30/109	—	—	—	—	30/109	—
Gauze Intake, Gauze .. .. .	—	—	—	—	—	—	—	—	30/110	—	—	—	—	30/110	—
Gauze Intake Clip .. .. .	—	—	—	—	—	—	—	—	30/080	—	—	—	—	30/080	—
Strangler Intake, complete .. .. .	—	—	—	—	—	—	—	—	—	—	—	—	—	—	—
Strangler Intake Cowl .. .. .	—	—	—	—	—	—	—	—	—	—	—	—	—	—	—
Strangler Intake Cowl Nut .. .. .	—	—	—	—	—	—	—	—	—	—	—	—	—	—	—
Strangler Intake Fixing Clip .. .. .	—	—	—	—	—	—	—	—	—	—	—	—	—	—	—
Strangler Intake Fixing Clip Pin .. .. .	—	—	—	—	—	—	—	—	—	—	—	—	—	—	—
Strangler Intake Fixing Pin Nut .. .. .	—	—	—	—	—	—	—	—	—	—	—	—	—	—	—
Strangler Intake Adaptor .. .. .	—	—	—	—	—	—	—	—	—	—	—	—	—	—	—
Plug Screw for Mixing Chamber Top .. .. .	—	4/137A	—	—	—	—	—	—	—	—	—	—	—	—	—



COMPONENT	276 AF BS BT BU CV EY	276 AT, AU CP, DS FT, FU, FV ED	276 AW FW	276 AX BN	276 BD, GA BF, DG FO FY, FZ	276 BG ES	276 BO	276 BM CB CH CJ DQ	276 CQ	276 CN DJ DR	276 CY DD DM	276 DA DE EF EG FQ	276 DB, DK DL, DU EA, EK EW, FE FF, FG FH, GE, GH	276 DP EC ER EU FD	276 DO
Mixing Chamber Body .. .. .															
Jet Block, complete .. .. .															
Mixing Chamber Top .. .. .	6/032	6/032	6/032	—	6/032	6/032	6/418	6/403	—	6/403	6/032	—	6/423	6/032	—
Mixing Chamber Cap Ring .. .. .	6/031	6/031	6/031	6/031	6/031	6/031	6/031	6/031	6/031	6/031	6/031	6/031	6/031	6/031	6/031
Fixing Spring for Cap .. .. .	4/235	4/235	6/248	6/248	4/235	4/235	4/235	4/235	4/235	6/248	4/235	6/419	4/276	4/235	4/235
Screw for Fixing Spring for Cap .. .. .	4/241	4/241	4/241	4/241	4/241	4/241	4/241	4/241	4/241	4/241	4/241	4/241	4/241	4/241	4/241
Cable Adjuster .. .. .	4/035	4/035	4/035	4/035	4/035	4/035	4/035	—	—	—	4/035	4/035	4/035	4/035	—
Cable Top Hat Ferrules .. .. .	—	—	—	6/132	—	—	—	6/132	—	6/132	—	—	6/132	—	6/132
Cable Tube .. .. .	—	—	—	5/204	—	—	4/278	—	4/278	—	—	—	—	—	—
Cable Tube Locknut .. .. .	—	—	—	—	—	—	4/279	—	4/279	—	—	—	—	—	—
Throttle Valve .. .. .	6/052	6/052	6/052	6/052	6/052	6/052	6/052	6/052	6/052	6/052	6/052	6/052	6/052	6/052	6/052
Throttle Valve Spring .. .. .	4/263	4/263	4/263	4/263	4/263	4/263	4/263	4/263	4/263	4/263	4/263	4/263	4/263	4/263	4/263
Throttle Valve Cotter Pin .. .. .	4/060	4/060	4/060	4/060	4/060	4/060	4/060	4/060	4/060	4/060	4/060	4/060	4/060	4/060	4/060
Taper Needle .. .. .	6/065	6/065	6/065	6/065	6/065	6/065	6/065	6/065	6/065	6/065	6/065	6/065	6/065	6/065	6/065
Needle Clip .. .. .	4/230	4/230	4/230	4/230	4/230	4/230	4/230	4/230	4/230	4/230	4/230	4/230	4/230	4/230	4/230
Air Valve .. .. .	6/045	6/045	6/045	—	6/045	6/045	6/045	6/045	6/045	—	6/045	6/045	—	6/045	6/045
Air Valve Guide .. .. .	6/047	6/047	6/047	—	6/047	6/047	6/047	6/047	6/047	—	6/047	6/047	—	6/047	6/047
Air Valve Spring .. .. .	4/046	4/046	4/046	—	4/046	4/046	4/046	4/046	4/046	—	4/046	4/046	—	4/046	4/046
Air Valve Ass'y, comp'te with M/c.Top & Con. Rod	—	—	—	30/304	—	—	—	—	30/318	—	—	6/417	—	—	6/422
Needle Jet .. .. .	4/061	4/061	4/061	4/061	4/061	4/061	4/061	4/061	4/061	4/061	4/061	4/061	4/061	4/061	4/061
Main Jet .. .. .	4/042	4/042	4/042	4/042	4/042	4/042	4/042	4/042	4/042	4/042	4/042	4/042	4/042	4/042	4/042
Mixing Chamber Union Nut .. .. .	6/062	6/033	6/062	6/062	6/062	6/062	6/062	6/062	6/062	6/033	6/062	6/062	6/062	6/062	6/062
Washer for Mixing Chamber Union Nut	6/040	6/040	6/040	6/040	6/040	6/040	6/040	6/040	6/040	6/040	6/040	6/040	6/040	6/040	6/040
Holding Bolt for Float Chamber .. .. .	4/043	4/043	4/043	4/043	4/043	4/043	4/043	4/043	4/043	4/043	4/043	4/043	4/043	4/043	4/043
Washer for Holding Bolt for Float Chamber	4/053	4/053	4/053	4/053	4/053	4/053	4/053	4/053	4/053	4/053	4/053	4/053	4/053	4/053	4/053
Pilot Air Adjusting Screw .. .. .	13/129	13/129	13/129	13/129	13/129	13/129	13/129	13/129	13/129	13/129	13/129	13/129	13/129	13/129	13/129
Pilot Air Adjusting Spring .. .. .	4/148	—	4/148	4/148	4/148	4/148	4/148	4/148	4/148	4/148	4/148	4/148	4/148	4/148	4/148
Pilot Air Adjusting Locknut .. .. .	—	16/010	—	—	—	—	—	—	—	—	—	—	—	—	—
Throttle Stop Screw .. .. .	—	—	4/063	4/063	4/063	4/063	4/063	4/063	4/063	4/063	4/063	4/063	4/063	4/063	4/063
Throttle Stop Screw Locknut .. .. .	—	—	16/010	16/010	16/010	16/010	16/010	16/010	16/010	16/010	16/010	16/010	16/010	16/010	16/010
Throttle Stop Screw with Tommy Bar .. .. .	15/2546	15/2546	—	—	—	—	—	—	—	—	—	—	—	—	—
Body for Th'tle St. Screw with T. Bar .. .. .	15/1860	15/1860	—	—	—	—	—	—	—	—	—	—	—	—	—
Screw for Th'tle St. Screw with T. Bar .. .. .	15/1988	15/1988	—	—	—	—	—	—	—	—	—	—	—	—	—
Spring for Th. St. Screw with T. Bar .. .. .	13/203	13/203	—	—	—	—	—	—	—	—	—	—	—	—	—
Outlet Clip .. .. .	—	*	—	5/200	*	5/200	—	*	—	—	—	—	—	—	—
Outlet Clip Screw .. .. .	—	4/048	—	4/048	4/048	4/048	—	4/048	—	—	—	—	—	—	—
Air Intake Tube .. .. .	6/038	—	6/038	6/038	6/038	—	—	6/038	—	6/038	—	6/038	—	—	—
Gauze Intake, complete .. .. .	—	30/201	—	—	—	—	—	—	—	—	—	—	—	—	—
Gauze Intake, Body only .. .. .	—	30/109	—	—	—	—	—	—	—	—	—	—	—	—	—
Gauze Intake, Gauze .. .. .	—	30/110	—	—	—	—	—	—	—	—	—	—	—	—	—
Gauze Intake Clip .. .. .	—	30/080	—	—	—	—	—	—	—	—	—	—	—	—	—
Gauze Intake, Adaptor .. .. .	—	—	—	—	—	—	34/015	—	—	—	—	—	—	—	—
Strangler Intake, complete .. .. .	—	—	—	—	—	—	244/290	—	—	—	—	—	—	—	—
Strangler Intake Cowl .. .. .	—	—	—	—	—	—	224/034	—	—	—	—	—	—	—	—
Strangler Intake Cowl Nut .. .. .	—	—	—	—	—	—	224/018	—	—	—	—	—	—	—	—
Strangler Intake Fixing Clip .. .. .	—	—	—	—	—	—	34/017	—	—	—	—	—	—	—	—
Strangler Intake Fixing Clip Pin .. .. .	—	—	—	—	—	—	15/927	—	—	—	—	—	—	—	—
Strangler Intake Fixing Pin Nut .. .. .	—	—	—	—	—	—	16/010	—	—	—	—	—	—	—	—
Air Intake Screwed Ring .. .. .	—	—	—	—	—	—	—	—	—	—	—	—	—	244/603	—

MIXING CHAMBER SPARE PARTS—continued

LIST No. 601/2 (ISSUE NO. 2)

COMPONENT	276 EM EN	276 EO	276 EP EQ	276 FS	276 FC	276 EV	276 FJ	276 FN FX	276 FR	276 GJ CG					
Mixing Chamber Body .. .. .								Refer to Settings List for Part Numbers							
Jet Block, complete .. .. .								Refer to Settings List for Part Numbers							
Mixing Chamber Top .. .. .	—	—	—	6/032	—	—	6/403	6/426	6/032	6/403	—	—	—	—	
Mixing Chamber Cap Ring .. .. .	6/031	6/031	6/031	6/031	6/031	6/031	6/031	6/031	6/031	6/031	—	—	—	—	
Fixing Spring for Cap .. .. .	6/248	4/235	6/248	4/235	6/248	6/248	6/248	6/248	6/248	4/235	4/276	—	—	—	
Screw for Fixing Spring for Cap .. .. .	4/241	4/241	4/241	4/241	4/241	4/241	4/241	4/241	4/241	4/241	4/241	—	—	—	
Cable Adjuster .. .. .	4/035	4/035	4/035	4/035	4/035	4/035	—	—	4/035	—	—	—	—	—	
Cable Top Hat Ferrules .. .. .	—	—	—	—	—	—	6/132	6/132	—	6/132	—	—	—	—	
Cable Tube .. .. .	—	—	—	—	—	—	—	—	—	—	—	—	—	—	
Cable Tube Locknut .. .. .	—	—	—	—	—	—	—	—	—	—	—	—	—	—	
Throttle Valve .. .. .	6/052	6/052	6/052	6/052	6/052	6/052	6/052	6/052	6/052	6/052	6/052	—	—	—	
Throttle Valve Spring .. .. .	4/263	4/263	4/263	4/263	4/263	4/263	4/263	4/263	4/263	4/263	4/263	—	—	—	
Throttle Valve Cotter Pin .. .. .	4/060	4/060	4/060	4/060	4/060	4/060	4/060	4/060	4/060	4/060	4/060	—	—	—	
Taper Needle .. .. .	6/065	6/065	6/065	6/065	6/065	6/065	6/065	6/065	6/065	6/065	6/065	—	—	—	
Needle Clip .. .. .	4/230	4/230	4/230	4/230	4/230	4/230	4/230	4/230	4/230	4/230	4/230	—	—	—	
Air Valve .. .. .	—	—	—	—	—	—	6/045	6/045	6/045	6/045	6/045	—	—	—	
Air Valve Guide .. .. .	—	—	—	—	—	—	6/047	6/047	6/047	6/047	6/047	—	—	—	
Air Valve Spring .. .. .	—	—	—	—	—	—	4/046	4/046	4/046	4/046	4/046	—	—	—	
Air Valve Assembly com. M/c. T. & C. Rod ..	30/304	6/417	6/417	—	6/417	6/417	—	—	—	—	—	—	—	—	
Needle Jet .. .. .	4/061	4/061	4/061	4/061	4/061	4/061	4/061	4/061	4/061	4/061	4/061	—	—	—	
Main Jet .. .. .	4/042	4/042	4/042	4/042	4/042	4/042	4/042	4/042	4/042	4/042	4/042	—	—	—	
Mixing Chamber Union Nut .. .. .	6/062	6/062	6/062	6/062	6/062	6/062	6/062	6/062	6/062	6/062	6/062	—	—	—	
Washer for Mixing Chamber Union Nut ..	6/040	6/040	6/040	6/040	6/040	6/040	6/040	6/040	6/040	6/040	6/040	—	—	—	
Holding Bolt for Float Chamber .. .. .	4/043	4/043	4/043	4/043	4/043	4/043	4/043	4/043	4/043	4/043	4/043	—	—	—	
Washer for Holding Bolt for Float Chamber ..	4/053	4/053	4/053	4/053	4/053	4/053	4/053	4/053	4/053	4/053	4/053	—	—	—	
Pilot Air Adjusting Screw .. .. .	13/129	13/129	13/129	13/129	13/129	13/129	13/129	13/129	13/129	13/129	13/129	—	—	—	
Pilot Air Adjusting Spring .. .. .	4/148	4/148	4/148	4/148	4/148	4/148	4/148	—	4/148	4/148	—	—	—	—	
Pilot Air Adjusting Locknut .. .. .	—	—	—	—	—	—	—	16/010	—	—	—	—	—	—	
Throttle Stop Screw .. .. .	4/063	4/063	4/063	4/063	4/063	—	—	4/063	4/063	4/063	—	—	—	—	
Throttle Stop Screw Locknut .. .. .	16/010	16/010	16/010	16/010	16/010	—	—	16/010	16/010	16/010	—	—	—	—	
Outlet Clip .. .. .	5/200	—	5/200	—	—	5/200	—	—	5/200	—	—	—	—	—	
Outlet Clip Screw .. .. .	4/048	—	4/048	—	—	4/048	—	—	4/048	—	—	—	—	—	
Air Intake Tube .. .. .	—	—	—	—	—	6/038	6/038	6/038	—	—	—	—	—	—	
Air Tube (Domed) .. .. .	30/310	—	30/310	—	—	—	—	—	—	—	—	—	—	—	
Gauze Intake, complete .. .. .	—	—	—	244/790	—	—	—	—	—	—	—	—	—	—	
Gauze Intake, complete .. .. .	—	30/109C	—	—	—	—	—	—	30/109C	—	—	—	—	—	
Gauze Intake, Body only .. .. .	—	30/109	—	—	—	—	—	—	30/109	—	—	—	—	—	
Gauze Intake, Gauze .. .. .	—	30/110	—	—	—	—	—	—	30/110	—	—	—	—	—	
Gauze Intake Clip .. .. .	—	30/080	—	—	—	—	—	—	30/080	—	—	—	—	—	
Gauze Intake Adaptor .. .. .	—	—	—	34/015	—	—	—	—	—	—	—	—	—	—	
Strangler Intake, complete .. .. .	—	—	—	—	—	—	—	—	—	—	—	—	—	—	
Strangler Intake Cowl .. .. .	—	—	—	—	—	—	—	—	—	—	—	—	—	—	
Strangler Intake Cowl Nut .. .. .	—	—	—	—	—	—	—	—	—	—	—	—	—	—	
Strangler Intake Fixing Clip .. .. .	—	—	—	—	—	—	—	—	—	—	—	—	—	—	
Strangler Intake Fixing Clip Pin .. .. .	—	—	—	—	—	—	—	—	—	—	—	—	—	—	
Strangler Intake Fixing Pin Nut .. .. .	—	—	—	—	—	—	—	—	—	—	—	—	—	—	
Plug Screw for Mix. Ch. Top .. .. .	—	—	—	4/137A	—	—	—	—	—	—	—	—	—	—	
Air Intake Screwed Ring .. .. .	—	—	—	—	—	—	—	—	—	244/603	—	—	—	—	



COMPONENT	89 B M	89 N	289 C, J L, Q Y	289 D G S T, V	289 M N 229 E, F	289 P	289 R	289 X	COMPONENT	1A	1B	1C	1D	1AV	1B
										1E, 1J 1AK 1AT 1BB 1BH 1DA, 1EJ	1F 1K 1AU 1BE 1BS, 1DB				1DO 1DV
Mixing Chamber Body ..			Refer to Settings List for	Part Numbers					Float Chamber Body only		Refer to Settings List for	Part Numbers			
Jet Block, complete .. ..			Refer to Settings List for	Part Numbers					Cover, complete .. ..	14/208	14/208	14/208	14/208	14/208	14/208
Mixing Chamber Top .. ..	29/042	29/042	29/042	29/300	29/300	29/042	29/300	29/309	Cover Lock Screw, St'd	14/021	14/021	14/021	14/021	14/021	14/021
Mixing Chamber Cap Ring ..	29/041	29/041	29/041	29/041	29/041	29/041	29/041	29/041	Cover Lock Screw, 1/8 inch	—	—	—	—	—	—
Fixing Spring for Cap .. ..	29/201	29/307	29/201	29/201	29/201	29/201	29/301	29/301	Cover Lock Screw .. ..	—	—	—	—	—	—
Screw for Fixing Spring for Cap	4/241	4/241	4/241	4/241	4/241	4/241	4/241	4/241	Tickler, complete .. ..	14/301	14/301	14/301	14/301	14/301	14/301
Cable Adjuster .. ..	4/035	4/035	4/035	—	—	—	—	4/035	Tickler, only .. ..	14/209	14/209	14/209	14/209	14/209	14/209
Cable Top Hat Ferrules .. ..	—	—	—	6/132	6/132	—	6/132	6/132	Tickler Spring .. ..	14/032	14/032	14/032	14/032	14/032	14/032
Cable Tube .. ..	—	—	—	—	—	—	—	—	Tickler Spring Screw ..	—	—	—	—	—	—
Cable Tube Locknut .. ..	—	—	—	—	—	—	—	—	Tickler Cotter Pin .. ..	14/289	14/289	14/289	14/289	14/289	14/289
Throttle Valve .. ..	29/062	29/062	29/062	29/062	29/062	29/062	29/062	29/062	Tickler Stop .. ..	14/210	14/210	14/210	14/210	14/210	14/210
Throttle Valve Spring .. ..	4/263	4/263	29/047	29/047	29/047	29/047	29/047	29/047	Float, complete .. ..	14/015	14/015	14/015	14/015	14/015	14/015
Throttle Valve Cotter Pin ..	4/060	4/060	4/060	4/060	4/060	4/060	4/060	4/060	Float Bow Spring .. ..	14/014	14/014	14/014	14/014	14/014	14/014
Taper Needle .. ..	29/075	29/075	29/075	29/075	29/075	29/075	29/075	29/075	Float Needle Valve .. ..	14/024	14/024	14/024	14/024	14/024	14/024
Needle Clip .. ..	4/230	4/230	4/230	4/230	4/230	4/230	4/230	4/230	Needle Clip .. ..	—	—	—	—	—	—
Air Valve .. ..	29/055	29/055	29/055	29/055	29/055	—	29/055	29/055	Plug Screw (Body Arm)	13/153	13/153	13/153	13/153	13/153	13/153
Air Valve Guide .. ..	29/057	29/057	29/057	29/057	29/057	—	29/057	29/057	Washer for Plug Screw	14/039	14/039	14/039	14/039	14/039	14/039
Air Valve Spring .. ..	4/046	4/046	4/046	4/046	4/046	—	4/046	4/046	Seating Locknut .. ..	14/178	—	—	—	—	—
Air Valve Ass. com. M/c T. & C.Rod.	—	—	—	—	—	—	—	—	Seating Washer .. ..	14/175	14/175	14/175	14/175	14/175	14/175
Needle Jet .. ..	29/076	29/076	29/076	29/076	29/076	29/076	29/076	29/076	Banjo Connection (S'gle)	—	14/035	—	—	—	14/054
Main Jet .. ..	4/042	4/042	4/042	4/042	4/042	4/042	4/042	4/042	Banjo Connection (D'ble)	—	—	14/043	14/173	14/043	—
Mixing Chamber Union Nut	29/078	29/078	29/078	29/078	29/078	29/078	29/078	29/078	Banjo Nut .. ..	—	14/036	14/036	14/036	14/036	14/036
Washer for Mix. Cham. Union Nut	29/050	29/050	29/050	29/050	29/050	29/050	29/050	29/050	Banjo Nut Washer .. ..	—	14/037	14/037	14/037	14/037	14/037
Holding Bolt for Float Chamber	29/077	29/077	29/077	29/077	29/077	29/077	29/077	29/077	Petrol Union Nut .. ..	14/042	14/042	14/042	14/042	14/042	—
Washer for Holding Bolt for F. Ch.	4/053	4/053	4/053	4/053	4/053	4/053	4/053	4/053	Petrol Union Nipple .. ..	14/026	14/026	14/026	14/026	14/026	—
Pilot Air Adjusting Screw ..	13/129	13/129	13/129	13/129	13/129	13/129	13/129	13/129	*Plug Screw (Modified)	64/353	64/353	64/353	64/353	64/353	64/353
Pilot Air Adjusting Spring ..	—	4/148	4/148	4/148	4/148	4/148	4/148	4/148	*Washer for ditto .. ..	23/110	23/110	23/110	23/110	23/110	23/110
Pilot Air Adjusting Locknut	4/206	—	—	—	—	—	—	—							
Throttle Stop Screw .. ..	4/063	4/063	4/063	4/063	4/063	4/063	4/063	4/063							
Throttle Stop Screw Locknut	4/206	4/206	16/010	16/010	16/010	16/010	16/010	16/010							
Outlet Clip .. ..	—	—	—	—	6/201	27/073	—	—							
Outlet Clip Screw .. ..	—	—	—	—	4/048	4/048	—	—							
Air Intake Tube .. ..	29/048(1/2")	29/048	29/048	229/300	29/048	—	—	—							
Gauze Intake, complete .. ..	—	—	—	—	—	—	—	—							
Gauze Intake, complete .. ..	—	—	—	—	—	—	—	—							
Gauze Intake, Body only .. ..	—	—	—	—	—	—	—	—							
Gauze Intake, Gauze .. ..	—	—	—	—	—	—	—	—							
Gauze Intake Clip .. ..	—	—	—	—	—	—	—	—							
Gauze Intake Adaptor .. ..	—	—	—	—	—	—	—	—							
Strangler Intake, complete ..	—	—	—	—	—	—	—	—							
Strangler Intake Cowl .. ..	—	—	—	—	—	—	—	—							
Strangler Intake Cowl Nut ..	—	—	—	—	—	—	—	—							
Strangler Intake Fixing Clip	—	—	—	—	—	—	—	—							
Strangler Intake Fixing Clip Pin	—	—	—	—	—	—	—	—							
Strangler Intake Fixing Pin Nut	—	—	—	—	—	—	—	—							

\*NOTE :—During the year 1950 all type 14/ and 64/ series or Complete type Nos. 1 and 2 Float Chambers were modified by increasing the diameter of the feed bore in the arm of the body. This necessitated the increase in sizes of the Plug Screw and Washer, the new parts numbers of these being :—

PLUG SCREW 64/353 and PLUG SCREW WASHER 23/110.

All modified Float Chambers bear the suffix letter "M." E.G., a No. 1A Float Chamber modified would become part No. 1A/M.

FLOAT CHAMBER SPARE PARTS—continued

LIST No. 601/2  
(ISSUE NO. 2)

COMPONENT	IDR IDQ	IDU	IDW	IDY IDZ IEM	IED IEF	IEH	2A 2J 2BH	2N 6BC	2DN 2DS	2DQ	2DX	2EK	2EN	14/092	3A 3J	3B	3EB	3EG	4A 4J	4EA
Float Chamber Body only																				
Cover, complete ..	14/208	14/208	14/208	14/208	14/208	14/208	14/012	14/297	14/297	14/297	14/012	14/356	14/012	14/012	22/011	22/011	62/212	22/011	22/012	62/223
Cover Lock Screw, St'd	14/021	14/021	14/021	14/021	14/021	14/021	—	—	—	—	—	—	—	—	—	—	—	—	—	—
Cover Lock Screw, 1/4 inch	—	—	—	—	—	—	—	3319	3319	—	—	—	—	—	—	—	—	—	—	—
Cover Lock Screw ..	—	—	—	—	—	—	—	—	—	—	—	—	—	—	—	—	62/204	—	—	62/204
Tickler, complete ..	14/301	14/301	14/301	14/301	14/301	14/301	14/301	14/301	14/301	14/301	—	—	14/301	14/301	22/053	22/053	—	—	22/053	—
Tickler, only ..	14/209	14/209	14/209	14/209	14/209	14/209	14/209	14/209	14/209	14/209	14/342	14/209	14/209	14/209	22/021	22/021	62/207	22/021	22/021	62/207
Tickler Spring ..	14/032	14/032	14/032	14/032	14/032	14/032	14/032	14/032	14/032	14/032	14/032	14/032	14/032	14/032	14/032	14/032	352/208	14/032	14/032	352/208
Tickler Spring Screw	—	—	—	—	—	—	—	—	—	—	—	—	—	—	—	—	352/207	—	—	352/207
Tickler Cotter Pin	14/289	14/289	14/289	14/289	14/289	14/289	14/289	14/289	14/289	14/289	14/289	14/289	14/289	14/289	14/289	14/289	—	14/289	14/289	—
Tickler Stop ..	14/210	14/210	14/210	14/210	14/210	14/210	14/210	14/210	14/210	14/210	14/210	14/210	14/210	14/210	22/037	22/037	—	22/037	22/037	—
Float, complete ..	14/015	14/015	14/015	14/015	14/015	14/015	14/017	14/017	14/017	14/017	14/017	14/017	14/017	14/017	22/016	22/016	22/016	22/016	22/016	22/016
Float Bow Spring	14/014	14/014	14/014	14/014	14/014	14/014	—	—	—	—	—	—	—	—	—	—	—	—	—	—
Float Needle Valve	14/024	14/024	14/024	14/024	14/024	14/024	14/030	14/030	14/030	14/030	14/343	14/355	14/030	14/030	22/013	22/013	22/013	22/013	22/014	22/014
Needle Clip ..	—	—	—	—	—	—	161/054	161/054	161/054	161/054	161/054	161/054	161/054	161/054	—	—	—	—	—	—
Plug Screw (Body Arm)	13/153	13/153	13/153	13/153	—	—	13/153	13/153	13/153	13/153	13/153	—	13/153	—	—	—	—	—	—	—
Washer for Plug Screw	14/039	14/039	14/039	14/039	—	—	14/039	14/039	14/039	14/039	14/039	—	14/039	—	—	—	—	—	—	—
Seating Locknut ..	—	14/178	—	—	—	—	—	—	—	—	—	—	—	—	14/178	—	14/178	—	—	—
Seating Washer ..	14/175	14/175	14/175	14/175	14/175	14/175	—	14/175	14/175	14/175	—	14/175	—	—	14/175	—	14/175	14/175	—	—
Banjo Connection (S'gle)	14/345	14/049	—	14/345	—	14/359	—	14/049	—	14/345	—	—	—	—	—	14/035	—	14/359	—	—
Banjo Connection (D'ble)	—	—	14/043	—	14/352	—	—	—	14/110	—	—	14/043	—	—	—	—	—	—	—	—
Banjo Nut ..	14/036	14/036	14/036	14/036	14/036	14/036	—	14/036	14/036	14/036	—	14/036	—	—	—	14/036	—	14/036	—	—
Banjo Nut Washer	14/037	14/037	14/037	14/037	14/037	14/037	—	14/037	14/037	14/037	—	14/037	—	—	—	14/037	—	14/037	—	—
Petrol Union Nut	14/308	—	14/042	—	—	—	14/042	14/042	—	14/308	14/042	14/042	14/308	14/042	14/042	14/042	14/042	—	14/042	—
Petrol Union Nipple	14/309	—	14/041	—	—	—	14/026	14/026	—	14/309	14/026	14/026	14/309	14/026	14/026	14/026	14/026	—	14/026	—
*Plug Screw (Modified)	64/353	64/353	64/353	64/353	64/353	64/353	64/353	64/353	64/353	64/353	64/353	64/353	64/353	64/353	—	—	—	—	—	—
*Washer for ditto	23/110	23/110	23/110	23/110	23/110	23/110	23/110	23/110	23/110	23/110	23/110	23/110	23/110	23/110	—	—	—	—	—	—

\*NOTE :—During the year 1950 all type 14/ and 64/ series or Complete type Nos. 1 and 2 Float Chambers were modified by increasing the diameter of the feed bore in the arm of the body. This necessitated the increase in sizes of the Plug Screw and Washer, the new parts numbers of these being :—  
PLUG SCREW 64/353 and PLUG SCREW WASHER 23/110.  
All modified Float Chambers bear the suffix letter " M ". E.G., a No. 1A Float Chamber modified would become part No. 1A/M.

GUARANTEE.—The Company take all possible reasonable care in the manufacture and the quality of their products. Purchasers are informed that, any part proved to be defective in manufacture or quality, and returned to the works within six months of its purchase new, will be replaced. The Company must respectfully point out however, that its responsibility and that of its agents, stockists and dealers, is limited to this Guarantee, and that they cannot, under any circumstances, be held responsible for any loss or for any contingent or resulting liability arising through any defect. These conditions of sale and use also apply when the Company's products form part of the original equipment of machines purchased new.

(THIS LIST IS PRINTED IN ENGLAND).

**AMAL LTD., Holdford Road, Witton, BIRMINGHAM, 6, England.**  
Telephone: Birmingham, BIRchfields 4571 (P.B.X. 6 lines). Telegrams: AMALCARB (PHONE), BIRMINGHAM.



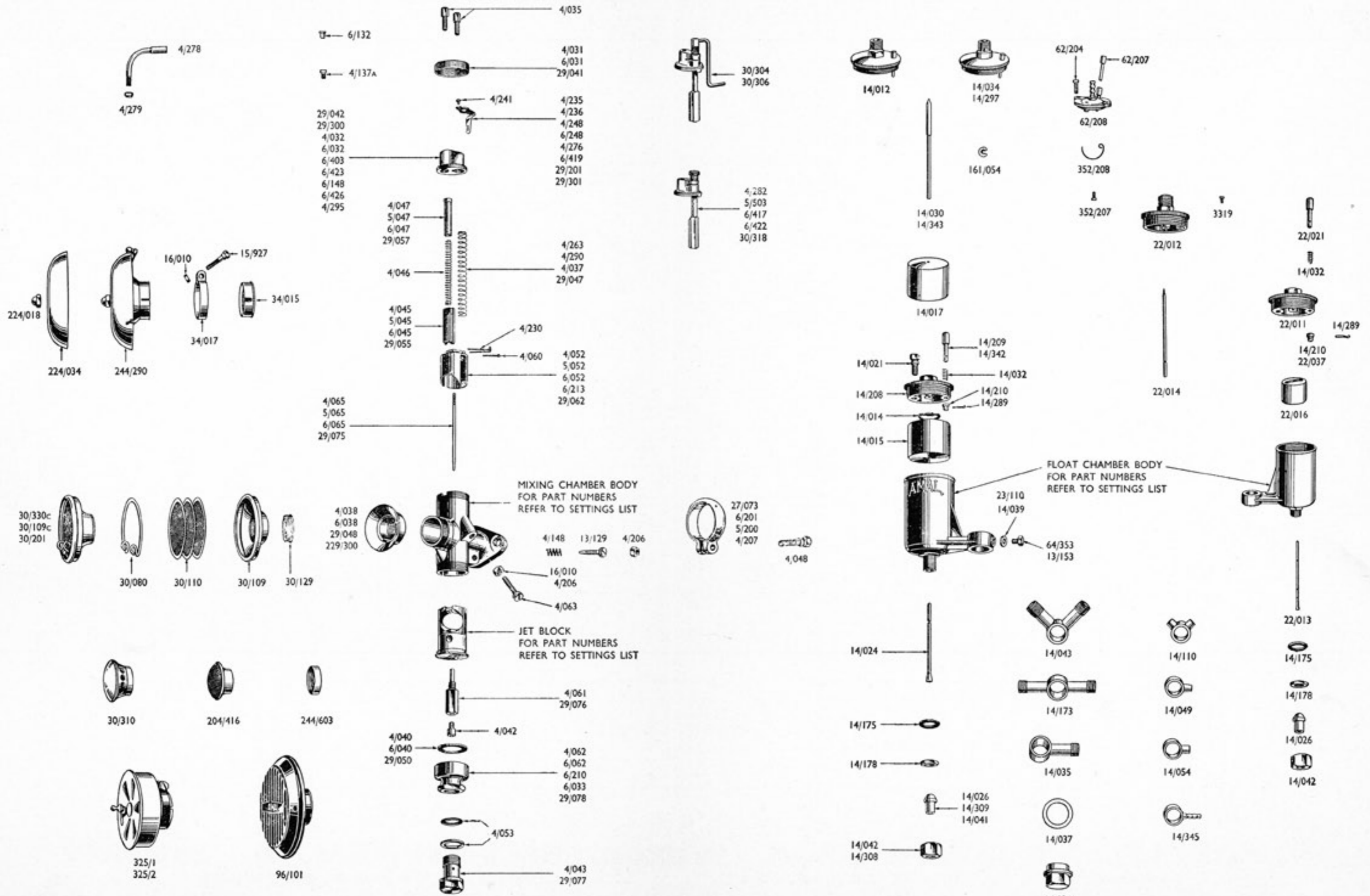

MIXING CHAMBER BODY  
FOR PART NUMBERS  
REFER TO SETTINGS LIST

JET BLOCK  
FOR PART NUMBERS  
REFER TO SETTINGS LIST

FLOAT CHAMBER BODY  
FOR PART NUMBERS  
REFER TO SETTINGS LIST

SPARE PARTS ILLUSTRATION FOR STANDARD NEEDLE TYPE CARBURETTORS